



Victoria del Mar





Victoria del Mar

SLEEPS 12 IN 7 STATEROOMS

BUILDER: DELTA MARINE

LAUNCHED: 2006/07

REFIT: 2014

LENGTH: 163'9" (49.91M)

BEAM: 33'1" (10M)

DRAFT: 9'7" (2.92M)

CRUISING SPEED: 15 KNOTS

STABILIZERS: AT ANCHOR (0 SPEED)

FLAG: JAMAICAN

COMMERCIAL REGISTRATION / MCA COMPLIANT

AMENITIES:

32 FT CENTURY TENDER

22 FT NAUTICA RIB JET 22 LIMITED

2X SEADOO RXP-X WAVERUNNERS

2X SEA BOBS

INFLATABLE BANANA

INFLATABLE TRAMPOLINE

INFLATABLE TUBES

INFLATABLE KAYAKS WITH 4X PADDLE

2X INFLATABLE PADDLE BOARD WITH 2X PADDLE

2X WATER SKIS

WAKEBOARD & TOW ROPE.

Not offered for charter to US residents while in US waters.

MAIN FOYER



The newly renamed Victoria del Mar has arrived on the charter market. Boasting a contemporary and tailored interior, an extreme beam of nearly 34-feet and a total of 7500 square feet of living area. The interior of the new Victoria Del Mar combines upscale elegance and comfort. The owners worked closely with Claudette Bonville Associates to create their vision and change the feel of the yacht's interior and exterior to a contemporary, crisp, tailored design.

MAIN SALON



Light colors, dark accents and phenomenal views



DINING ROOM





In the dining room, a custom-made glass chandelier and glass table for twelve, both created by the artist Chico, are sure to impress. Large windows on both the port and starboard sides ensure that you will be able to enjoy the view with your five-star meal.

SKYLOUNGE



Private Skylounge



Inside the sky lounge, light woods and pale fabrics lend this beamy yacht an incredibly spacious feeling while intricate details like the carved glass door or the bar-top made of petrified wood. An unexpected treat on this level is the twin balconies tucked in to the port and starboard sides of the yacht, the perfect place to watch the sun set (or rise) while sipping your favorite drink or curled up with your new favorite book.

MASTER SUITE



A private haven and the perfect vacation



MASTER BATH



A small entry and dressing area gives access to either the mosaic-tiled bathroom with twin custom-made glass bowl sinks, jettted tub, separate shower and enclosed toilet or the full-beam master bedroom beyond.



VIP SUITES



Accommodating even the highest standards







WORLDWIDE
CRUISING

GYM/SPA ROOM/LIBRARY





Forward on the main deck and you will pass through the small library and reading area until you reach the gym, which can transform into a massage room.

GUEST ACCOMMODATIONS



Comfort and peace on the high seas



The remaining guest accommodations are amidships on the lower deck. Four mirror-image suites—two twin and two queen—offer your guests plenty of options when it comes time to retire for the night or a mid-day nap. No matter which suite they choose, they will enjoy the beautifully mosaic-tiled bathroom with the custom glass bowl sink, soft linens and fantastic service.

SUN DECK



Fabulous exterior living areas



One of the most popular onboard destinations is probably going to be the spacious sundeck. A hot tub and connected sunpad create a sun-worshippers paradise or you could choose one of the several stainless steel and teak loungers to relax on. Centered on the deck is a half-covered seating area and just forward of this perfect conversation spot is the enormous al fresco dining table that can seat up to 18.





To port of the dining table is an air-conditioned day head with shower. As if all of that isn't enough, the sundeck also includes a large, full-service wetbar with stool seating for eight and a long settee for relaxing in the shade with a cool drink on a hot day. When the sun begins to set, you can enjoy a movie under the stars on a large, double-sided screen that can be viewed from anywhere on the sundeck. Ready for air-conditioning? The elevator will carry you to any of the yacht's four decks.

MAIN AFT DECK



The covered main aft deck has a long, curved settee and several chairs surrounding small tables, the perfect spot for an evening cocktail before dinner.



OWNERS DECK



Relax and reward yourself



The sumptuous master suite opens directly onto a semi-private enclosed aft deck where a leather settee and several comfortable armchairs create a cozy spot to relax. If the weather is good, remove the windows and let the breeze in, but should a storm roll in, you can watch the rain fall from the comfort of your climate-controlled haven. Use the space to enjoy a private breakfast or invite several of your guests up for lunch—the table here can seat six!

PILOTHOUSE



Explore the seas

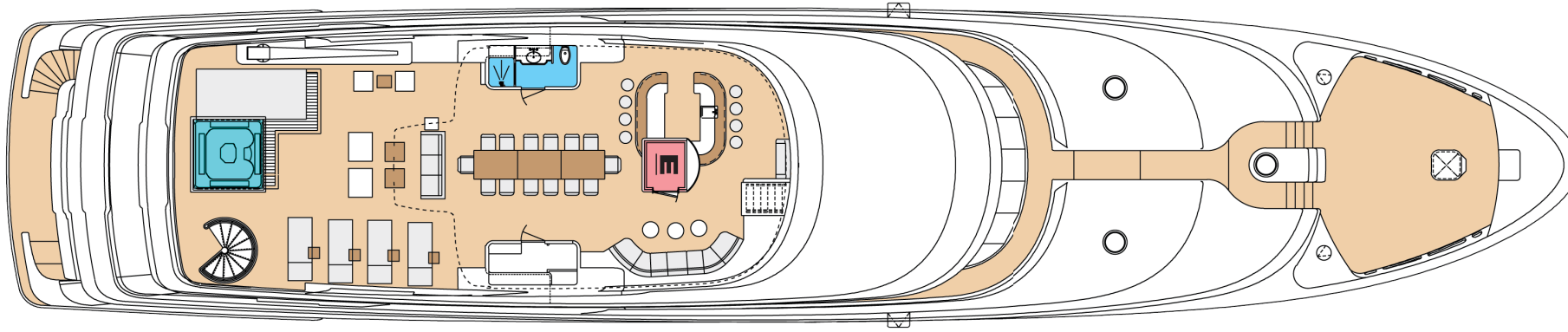

SUN DECK

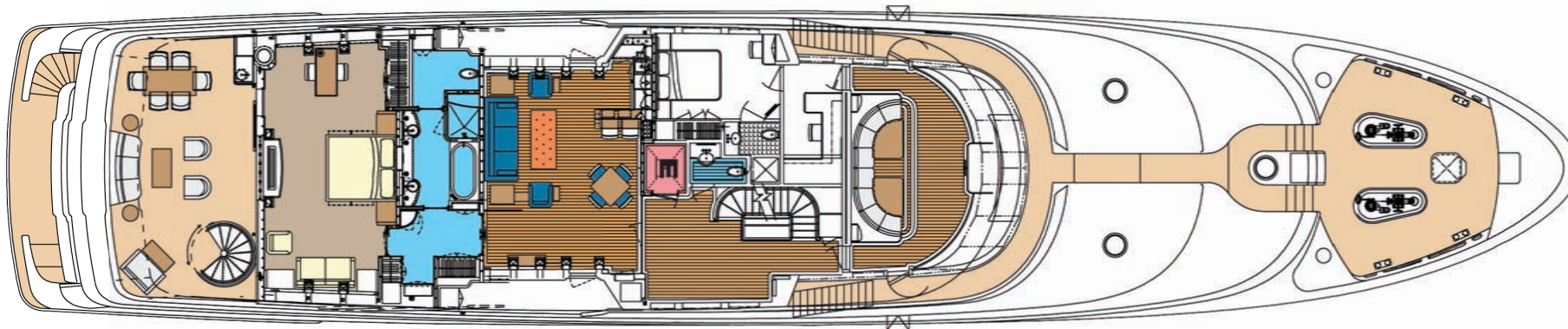

OWNERS DECK / PILOTHOUSE

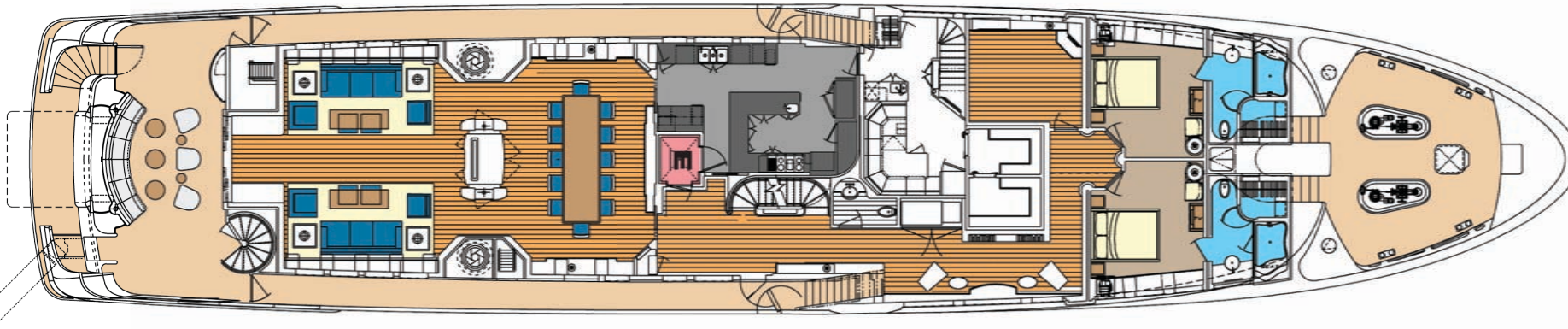

MAIN DECK

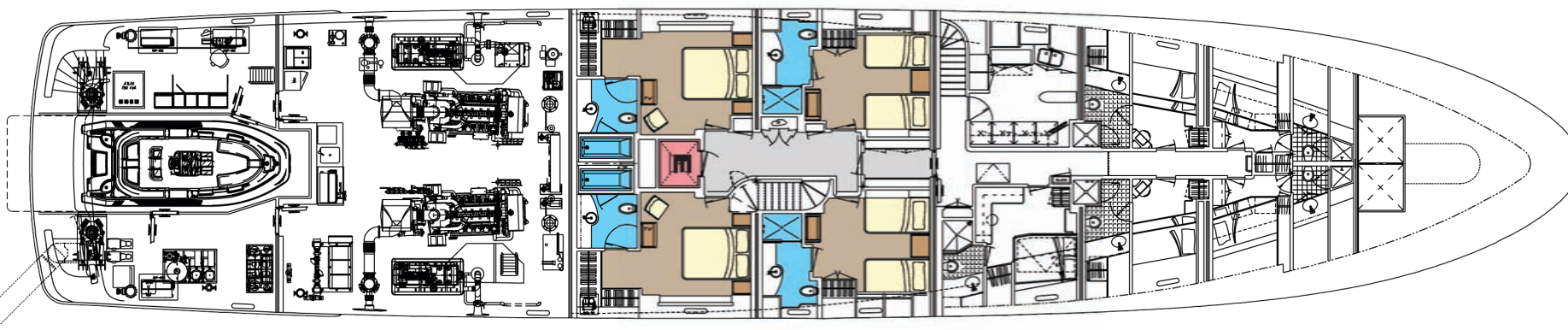

LOWER DECK





