

SEATALY

C H A R T E R   Y A C H T







































# KEY FEATURES

- Vast and spacious sundeck
- Winner of 'Most Innovative Yacht' at Cannes Yachting Festival 2016
- Winner of 'Yacht Aviation Awards 2017' in flooring category
- Eco-Friendly Yacht
- Maximum number of 25 guests allowed for static events
- Maximum speed up to 28 Knots





# AMENITIES

- Paola Lenti exterior furniture
- Jacuzzi on board
- Zero Speed Stabilisers
- E-bike on board

SEATALY





# TENDERS & WATER TOYS

- 1 x Tender 4 mt HONDA 40HP
- 1 x Seabob
- 2 x Stand up paddle board
- 1 x Waterski (can also be used as Mono ski)
- N° 1 Rumble Jobe 1-person
- N°1 Storm Jobe 2-person
- 10 x Snorkeling gear
- Fishing Equipment
- 1 Electronic Bike





# SPECIFICATIONS

Accommodates	10 Guests in 5 Staterooms
Arrangements	5 King, 4 Convertible
Length	97'1" (29.60m)
Beam	23' (7.00m)
Draft	6'5" (1.95m)
Year / Refit	2016
Builder	PerMARE (Amer Cento Quad)
Interior Designer	Stefano Tini and Massimo Verme
Engines	Engines: 4xVolvo Penta IPS 1050
Cruising Speed	24 knots
Max Speed	28 knots
Fuel Consumption	12 Knots = 125 liters x hour
	21 knots = 475 liters x hour
	25 knots = 550 liters x hour
	These are the consumptions including the generators.





GENERAL ARRANGEMENT

Lower Deck

STEFANO TINI ARCHITETTO  
y a c h t d e s i g n

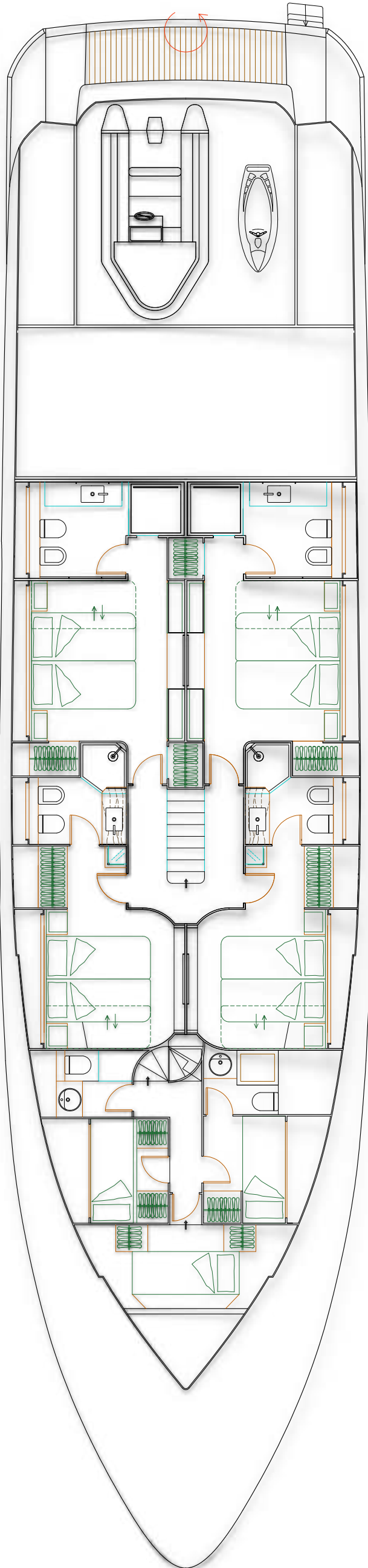

Main Deck

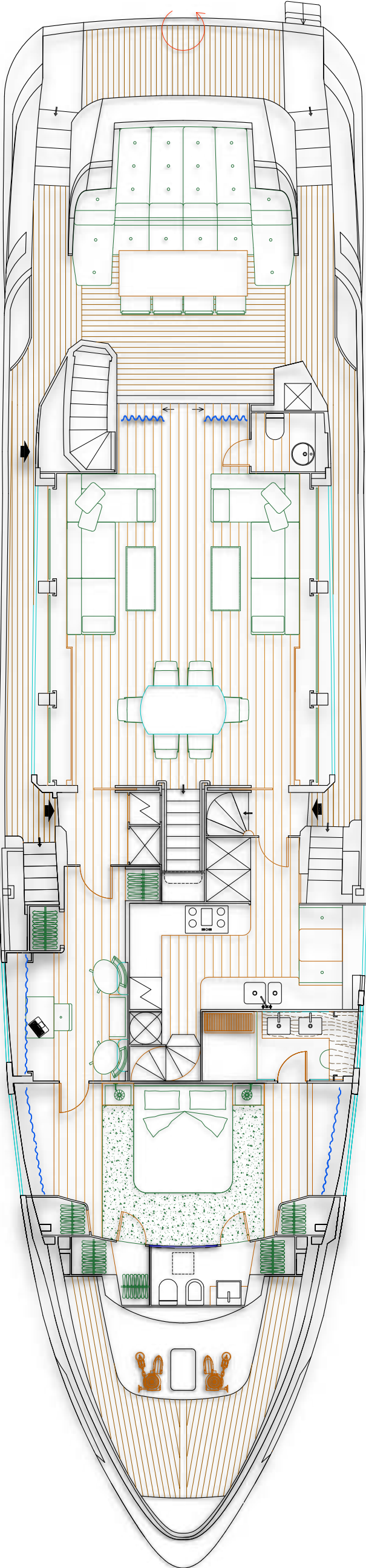

Upper Deck

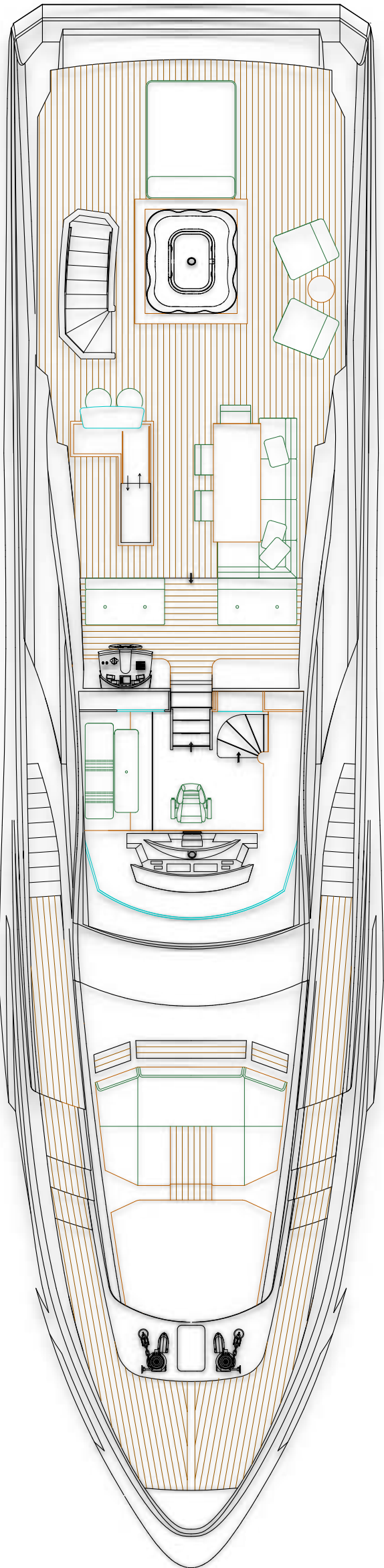



# SEATALY

C O N T A C T   Y O U R   C H A R T E R   B R O K E R