

An aerial photograph of a white sailboat with a large white sail, sailing on a blue ocean. The boat has a wooden deck and a white cabin. A red flag with a white Union Jack is flying from the stern. The name 'Roseheart' is visible on the stern. The word 'Roseheart' is written in a large, white, cursive font across the center of the image.

Roseheart

Roseheart
HAMILTON



Roseheart is a stunning design by Perini Navi, with interiors by renown French designer Christian Liaigre.







AN EXCITING SAILING EXPERIENCE

Rosehearty, a 56-metre luxury sailing yacht by Perini Navi, has few peers. Her classic beauty is a combination of a white hull with long lean lines, smooth curves and black tinted wrap-around windows. Her extreme stability and race speed enhance your sailing experience.

Rosehearty can accommodate up to 12 charter guests in seven spectacularly stylish cabins. Her interior is one of the rare yacht designs by the noted

French designer Christian Liaigre. Crisp white linen sofas, Hermès leather banquettes and beautiful wood define Rosehearty's look.

One of the fastest yachts in the Perini Navi fleet, Rosehearty, has been tested against the other great yachts produced by the legendary Italian boatbuilder. In 2015 she was the fastest Perini in the St Barths Bucket Regatta and she won the 2015 Perini Navi Cup, which was held off the coast of Sardinia.

For those who charter Rosehearty, there is comfort in knowing that the yacht they are enjoying has the ability to perform at speed with comfort and luxury.





BUILT FOR COMFORT

Rosehearty features large open-air deck spaces with many seating and lounging areas inside and out, a custom cockpit layout with alfresco dining for 12+ guests, and a heated Jacuzzi. The fully-shaded aft deck dining and lounge area has a 60-inch television and leads into the spacious main saloon. The interior design created by noted French designer Christian Liaigre is an original combination of classical marine tradition and contemporary elegance.

The innovative use of space and materials adopted by Liaigre further enhances the yacht's very comfortable layouts.



MAIN SALON SEATS UP TO 30



OUTDOOR DINING TABLE AND SEATING



OUTDOOR COVERED DINING SEATS UP TO 14



FLY BRIDGE COVERED SEATING



OUTDOOR SEATING & CINEMA



JACUZZI ON THE FLY BRIDGE



AFT DECK WITH CHAISE LOUNGES AND UMBRELLA

BEAUTIFULLY APPOINTED SUITES

Rosehearty has seven beautifully appointed suites. She has a full beam Master Suite; two identical VIP suites with queen berths; two identical cabins each with a double and a single bed; a double cabin with over and under single berths; and, unlike any other yacht in the Perini Navi fleet, an on-deck suite with a double bed. Each suite comes with a private bath. (The Master Suite has two full bathrooms.) Amenities include voluminous storage, superb bathrooms and seating with makeup vanities.



SEATING FOR MAKEUP VANITY



MASTER BEDROOM WITH 2 FULL BATHS AND VOLUMINOUS CLOSETS



2 GUEST ROOMS WITH QUEEN BEDS



PRIVATE GUEST BATH



PRIVATE GUEST BATH & SHOWER AREA



2 GUEST ROOMS EACH WITH A DOUBLE & A TWIN BED

OUTFITTERED FOR FUN & ENTERTAINMENT

Rosehearty's impressive leisure facilities make her the ideal charter yacht for socializing and entertaining with family and friends. She offers excitement in the form of two jet skis, a fly board, water skis, wake boards and other water adventures. Platforms at the stern and port side allow easy water access for swimming. The teak decks have multiple awnings, covers, and umbrellas to offer shade for on-deck relaxation. There are chaise lounges and a BBQ on the aft deck. And of course a heated Jacuzzi available into the evening.



2 JET SKIS FOR YOUR GUEST'S ENJOYMENT



FLY BOARD AND ONE OF THE TWO JET SKIS



20FT NOVURANIA TENDER AND 45FT WALLY TENDER



ONE OF TWO SEABOBS ON A SWIMMING PLATFORM



LOUNGE WITH CINEMA

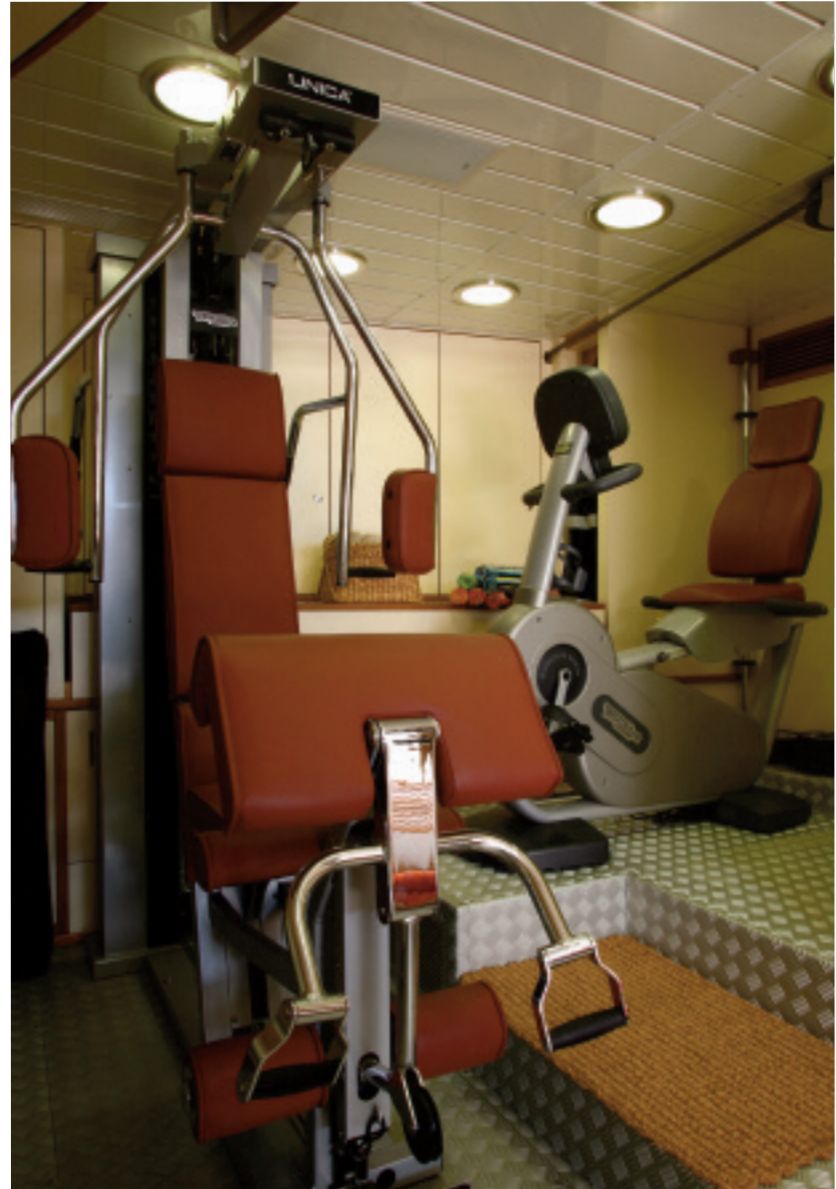

EXTENSIVE EXERCISE EQUIPMENT

MAIN DECK

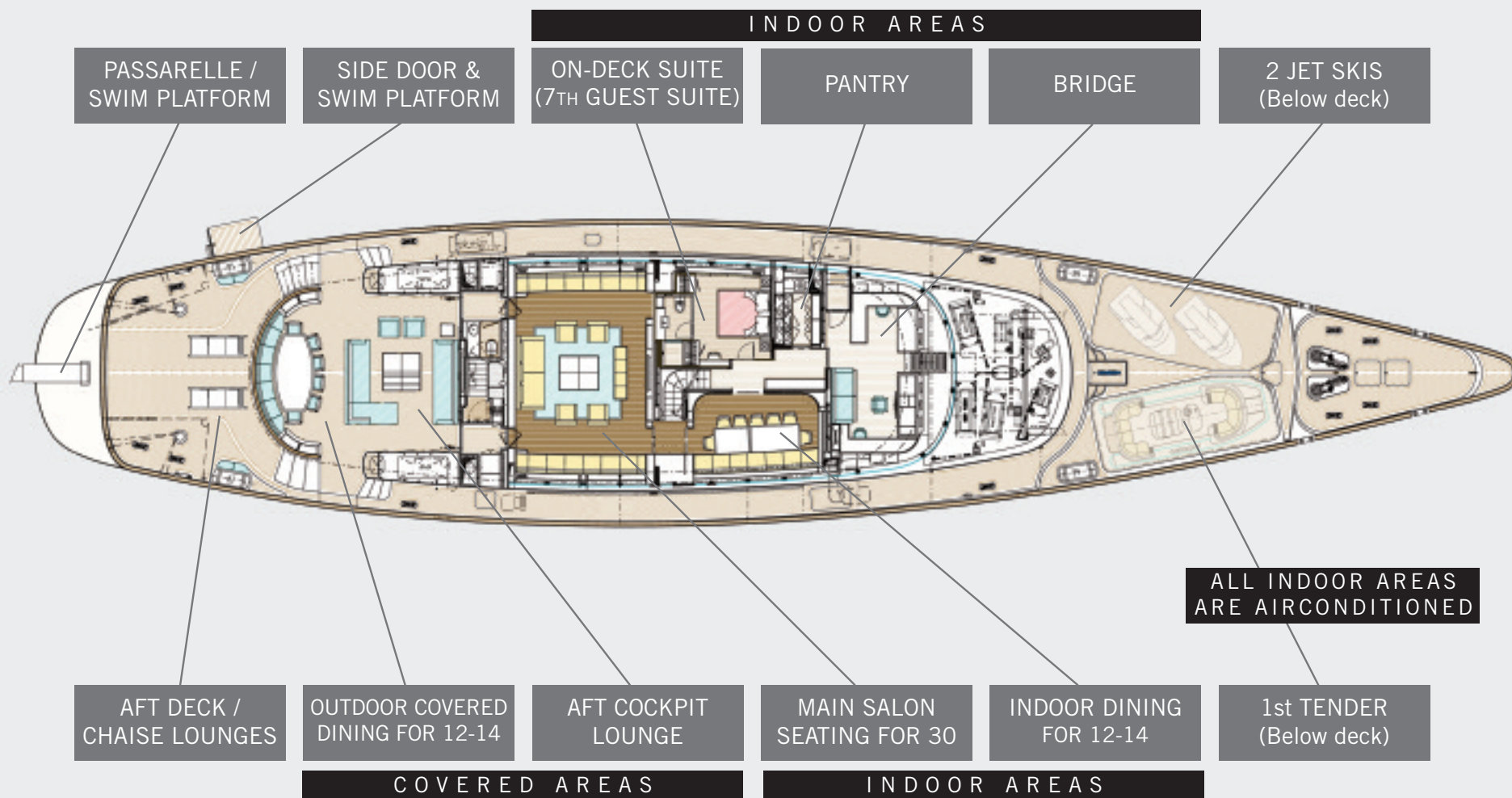

FLY BRIDGE

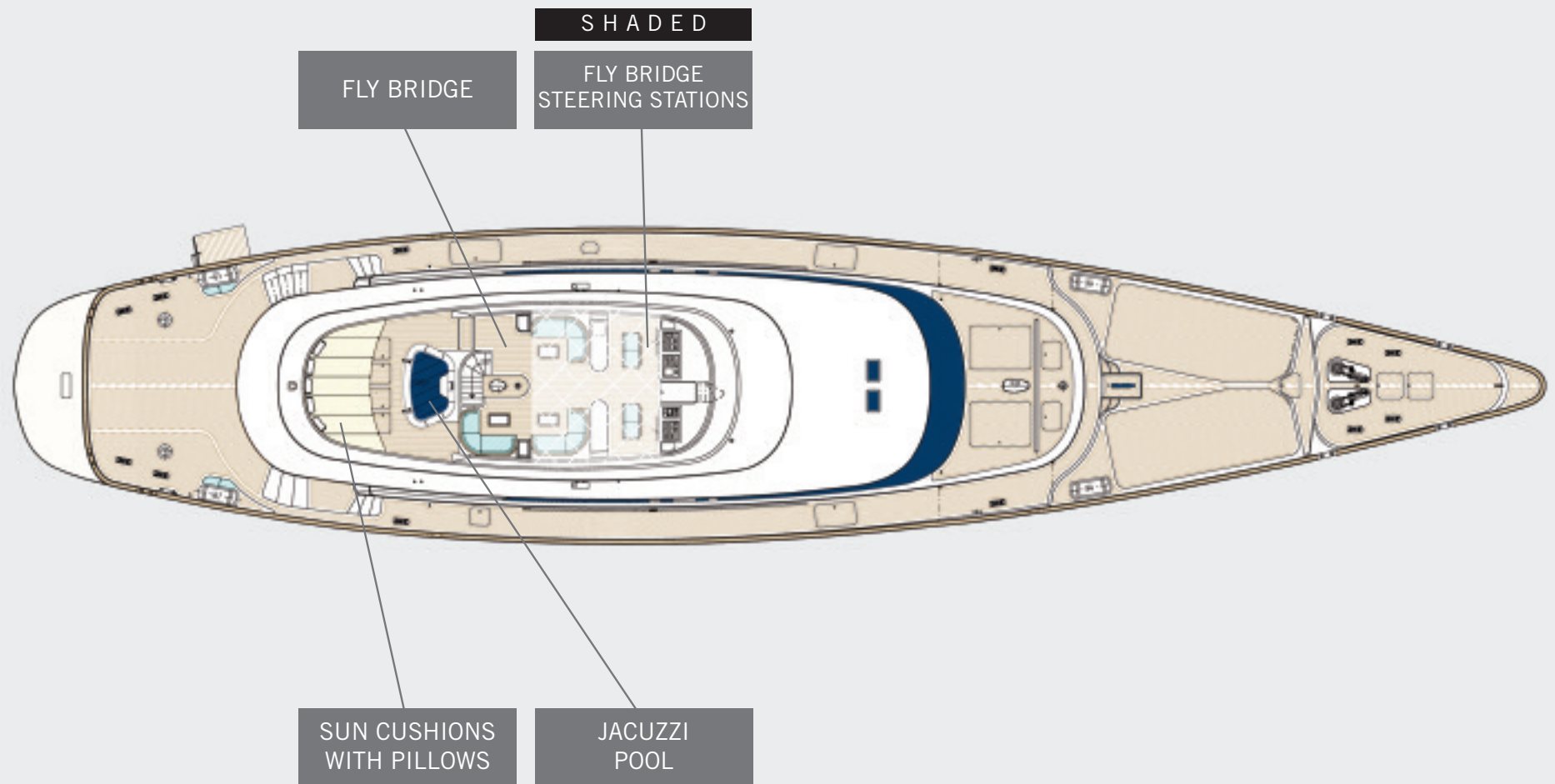

LOWER DECK

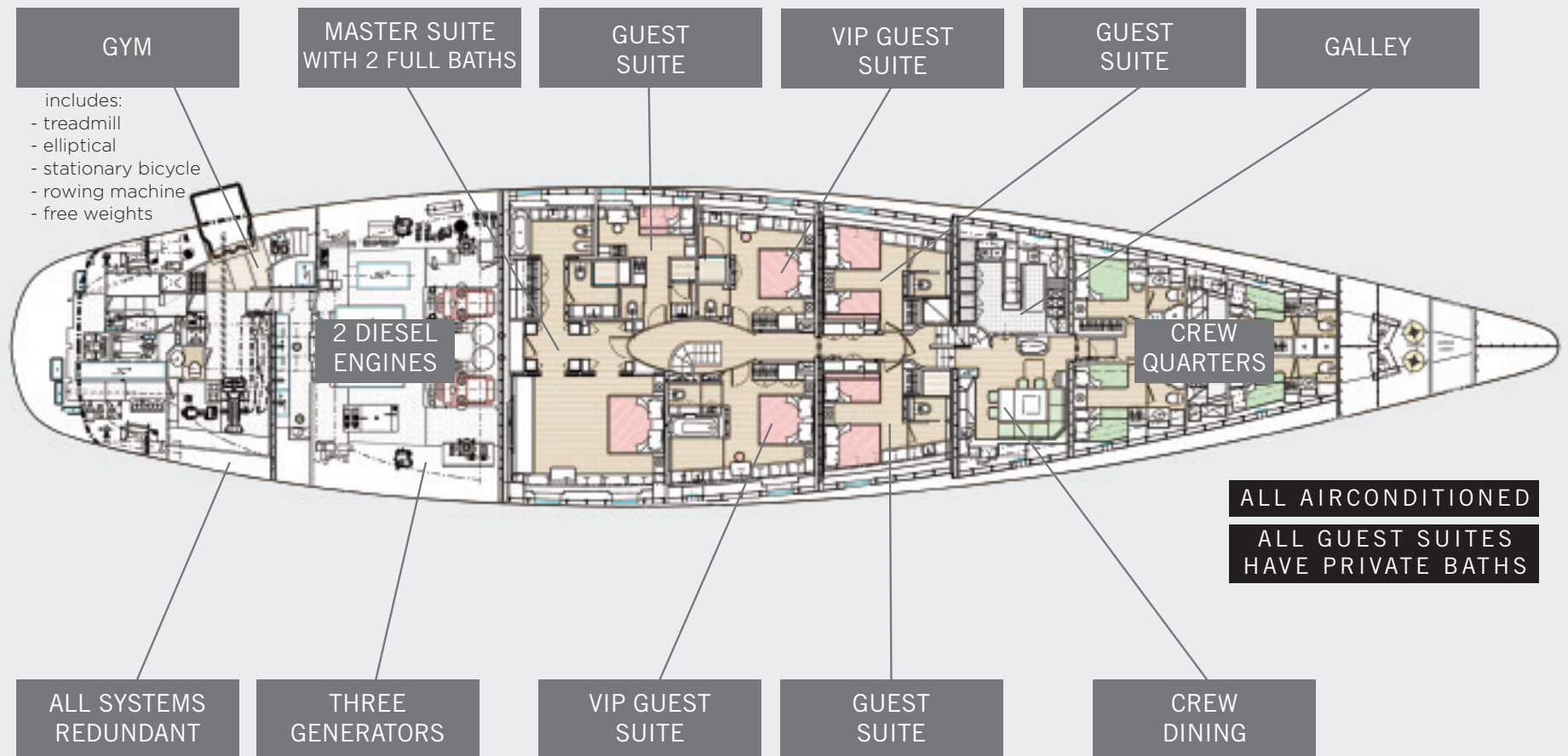

HIGHLIGHTS

Builder:

Perini Navi

Year Built:

2006

Years Full Refit:

2014 / 2015

Guest Cabins:

7

Guests:

12

Crew:

11

Length:

56-metre (184-ft)

Cruising speed:

13 knots

Maximum sailing speed:

17 knots

Interior Design:

Christian Liaigre

Hull Design:

Ron Holland

AMENITIES

- WiFi Internet
- 20ft Novurania Tender 260hp
- 45ft Wally Tender "Annalu"
- Side and rear swimming platforms
- On-deck Jacuzzi
- Flybridge sun awning
- 9 AppleTVs to stream music and movies from iPhones/iPad
- Central hardrive using 10 wireless routers to provide complete wifi coverage
- Televisions in each of 7 suites with access to all forms of entertainment
- 2,000+ DVD, BluRay, and 3D BluRay collection
- BluRay players, Satellite TV Boxes, iPod docks and gaming systems
- SAT TV is available using SkyTV, DirecTV, and Free to Air boxes
- 2x Wii (US & European) with games, steering wheel, and 4 controllers
- Playstation2 w/games and 4 controllers
- Newspaper downloading available onboard

ACTIVITIES

- 2 Jet Skis
- Water Skis
- Fly Board
- Wake Boarding
- Scuba Diving (RDV only)
- Snorkeling
- Exercise Equipment
 - treadmill
 - elliptical
 - rowing machine (Concept II)
 - stationary bicycle
 - free weights
- 2 Seabobs
- Fishing
- Training and licensing available for all equipment

SPECIFICATIONS

Length overall: 56m (184ft)

Waterline length: 46.71m (153ft)

Beam: 11.51m (38ft)

Draught (keel up): 3.95m (13ft)

Draught (keel down): 9.73m (32ft)

Hull and superstructure: Aluminium

Maximum displacement: 558T

Gross registered tonnage: 499grt

Main engines: 2 Deutz TBD616

Maximum power: 2 x 924kW

Speed at maximum power: 18kt

Speed at maximum continuous rating: 13kt

Maximum sailing speed: 17 knots

Range at 13 knots: 3,600nm

Fuel capacity: 56,000 litres

Fresh water: 17,000 litres

Main mast height above DWL: 59.09m (194ft)

Mizzen mast height above DWL: 48.26m (158ft)

Total sail area (without spinnaker): 1,500m²
(16,146 sq ft)

Total deck area: 436m² (4,693 sq ft)

**Cockpit and
flybridge area:** 128m² (1,378 sq ft)

**Saloon and
wheelhouse area:** 133m² (1,432 sq ft)

**Total owner and
guest cabin area:** 157m² (1,690 sq ft)

Total crew area: 100m (1,076 sq ft)

**Lazarette and
gym area:** 42m² (452 sq ft)

Classification: A.B.S.: ✱ A1Yachting
Service AMS + MCA

Registration: Isle of Man

Launched: December 2005

Delivered: January 2006

Refit completed: 2014/15 at Perini Navi Viareggio

Interior Design: Christian Liaigre

Naval Architecture: Perini Navi, Ron Holland

Builder: Perini Navi Viareggio, Italy