

ONE MORE TOY

L U X U R Y C H A R T E R Y A C H T

















KEY FEATURES

- Elevator to all 4 decks
- Zero-speed stabilizers
- Sleeps 12 in 6 Staterooms including Full-beam Master Stateroom
- Full suite of water toys including water slide
- Huge Interior and Exterior spaces, perfect for Entertaining
- Shallow draft great for cruising the Bahamas and Caribbean



TENDERS & WATER TOYS

- 32ft Boston Whaler with 2x 300hp Mercury engines
- 21 ft. Zodiac inflatable tender with 1x 115hp Yamaha engine
- 2x Yamaha wave runner jet skis
- 1x Inflatable jet ski dock (holds both jet skis)
- 1x 2 seater towable couch
- 1x 1 seater towable doughnut
- 1x towable banana
- 1x inflatable trampoline
- 2x 2 seater inflatable kayaks
- 2x inflatable stand-up paddle boards
- Full snorkel gear
- 5 sets of scuba diving gear with a compressor to refill
- 1x wake board
- 1x knee board
- Water skis
- Beach set up
- Assorted fishing equipment
- Exercise Equipment:
 - 1x new treadmill
 - 1x Stationary bike
- Yoga mats
- Assortment of weights
- Skipping ropes

ONE MORE TOY



SPECIFICATIONS

Accommodates	12 Guests in 6 Staterooms
Arrangements	4 Double, 2 Twin
Length	155' (47.24m)
Beam	27'11" (8.51m)
Draft	8' (2.44m)
Year / Refit	2001 / 2018
Builder	Christensen
Engines	2 x MTU DDC 16V2000 1800 hp
Cruising Speed	14 knots
Max Speed	20 knots
Fuel Consumption	74 US Gall/Hr
Range	2.600nm
GRT	462



ONE MORE TOY

GENERAL ARRANGEMENT

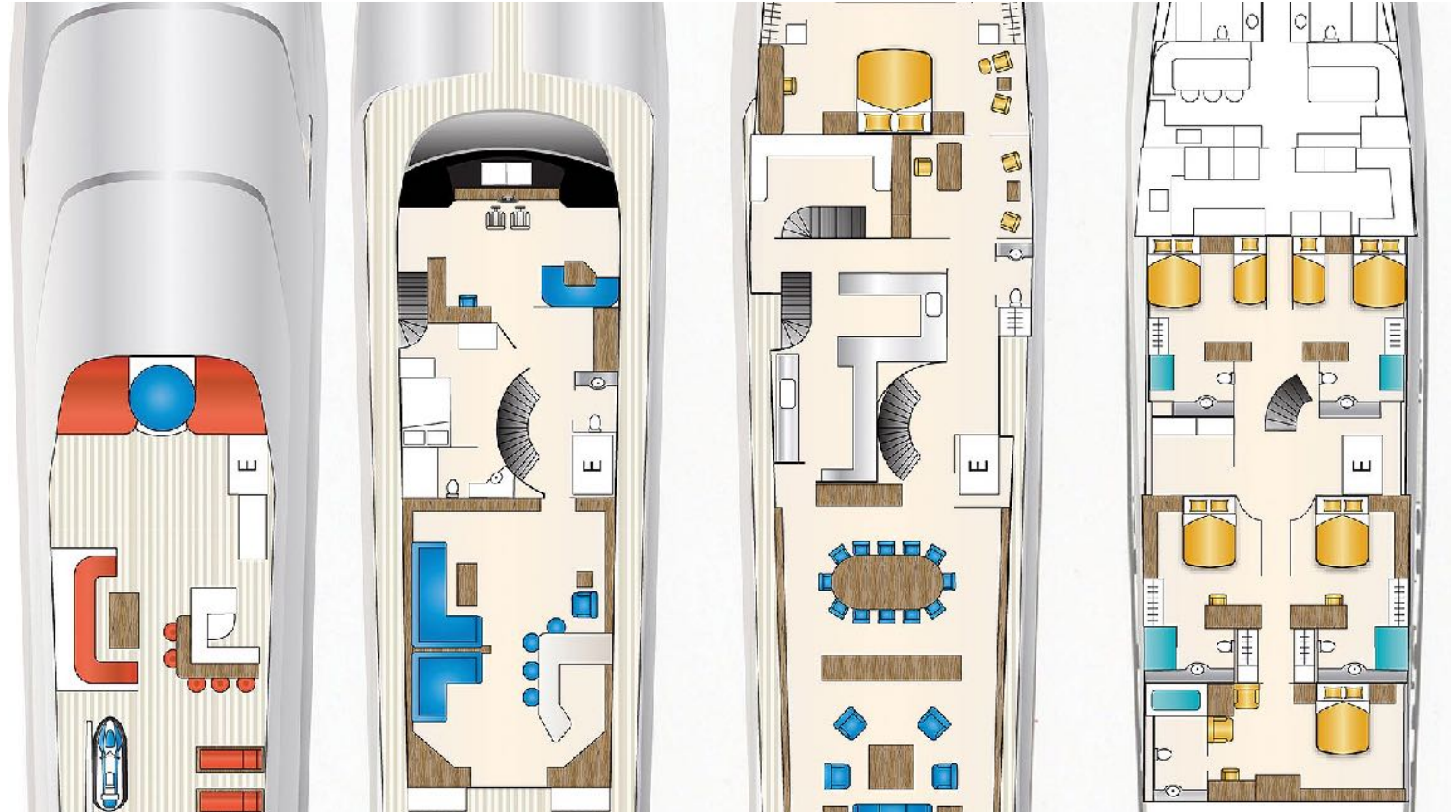

ONE MORE TOY

C O N T A C T Y O U R C H A R T E R B R O K E R