

OCEAN CLUB

C H A R T E R Y A C H T









OCEAN CLUB



SPLIT-LEVEL MASTER STATEROOM & EN SUITE







OCEAN CLUB



SKYLOUNGE















KEY FEATURES

- Award-winning luxury yacht with a chic, timeless interior by Patrick Knowles
- Impressive split-level master stateroom on the main deck, featuring a raised observation lounge forward with 270 degrees of visibility
- Al fresco dining on skylounge aft deck
- Private lounge forward to enjoy breathtaking views
- Kaleidescape movie and music central server with Crestron controls throughout
- Zero Speed Stabilizers
- Movie screen on the sun deck
- Experienced, fun and dynamic crew!

OCEAN CLUB



TENDERS & TOYS

- › 40ft Formula 400 Super Sport Crossover tender
- › 20ft Williams RIB jet tender with 270hp engine
- › 4 x 3-person Yamaha VX WaveRunners - NEW 2021
- › Waterslide
- › 2 x SeaBobs
- › 2 x Lift E-Foils- NEW 2021
- › 2 x Paddle boards
- › 2 x Kayaks
- › 2 x GO electric bikes
- › 5 x NautiBuoy floating docks
- › 1 x Wakeskate
- › 1 x Kite surfing rig
- › Towable toys, waterskis, wakeboard
- › Snorkeling gear
- › Spear fishing gear
- › Exercise equipment (bridge aft deck): Elliptical, yoga mats & free weights
- › Upper dining table converts to ping pong table

OCEAN CLUB



SPECIFICATIONS

Accommodates	12 Guests in 5 Staterooms
Arrangements	2 Pullman, 4 King, 2 Single
Length	164' (50m)
Beam	27' 11" (8.51m)
Draft	8' 5" (2.57m)
Year / Refit	2009 / 2018
Builder	Trinity Yachts
Interior Designer	Patrick Knowles
Engines	2 x Caterpillar 2,250 hp each
Cruising Speed	14 knots
Max Speed	16.5 knots
Fuel Consumption	88 US Gall/Hr
Range	3,000 nm @ 10 knots
GRT	442

sun deck

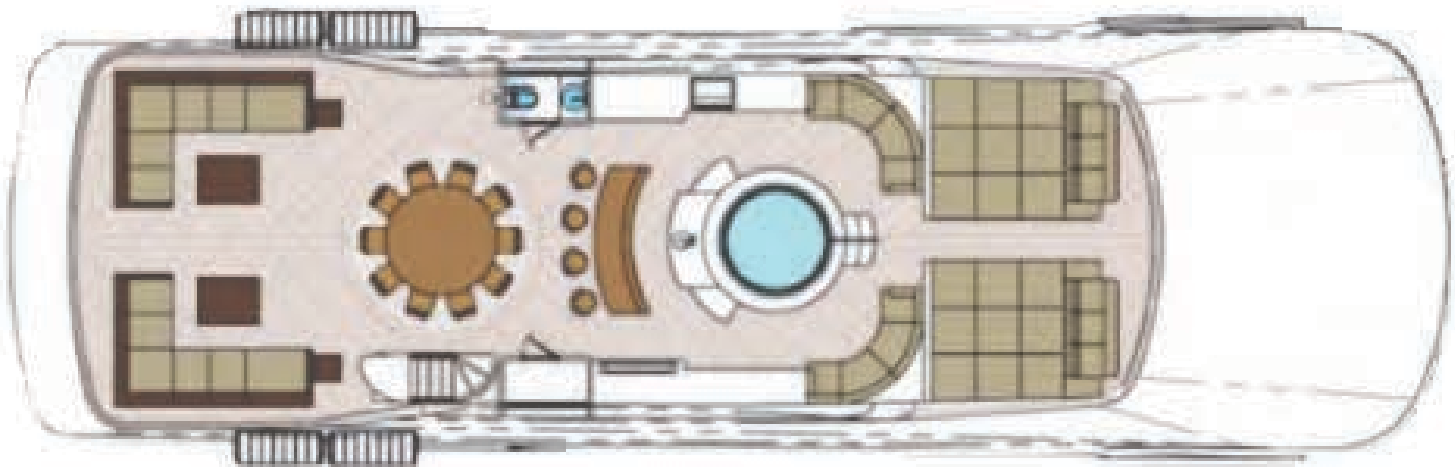

upper deck

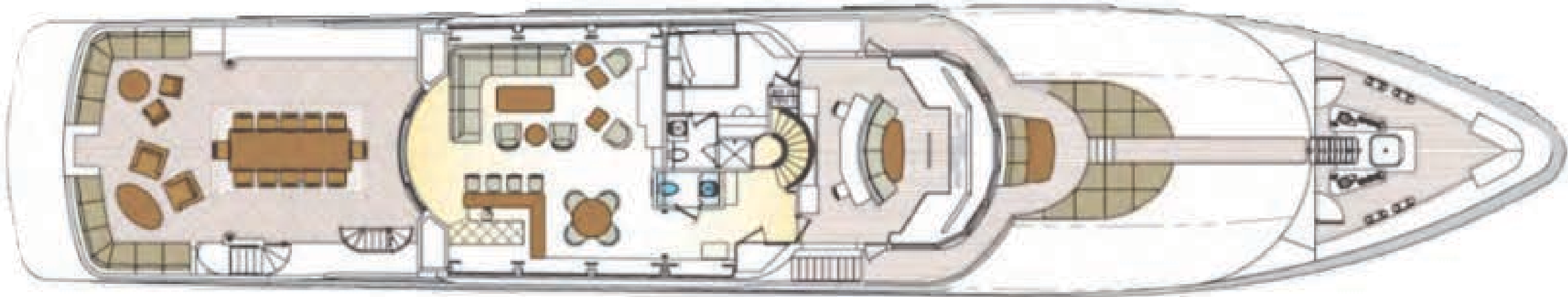

main deck

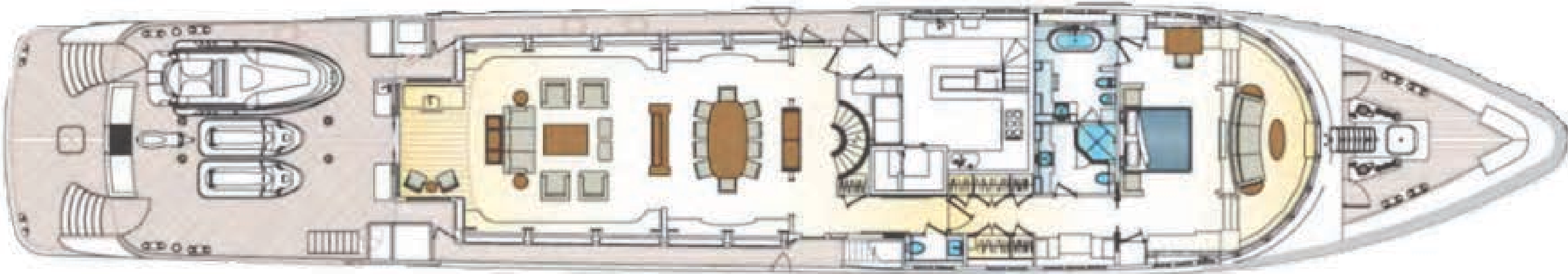

lower deck

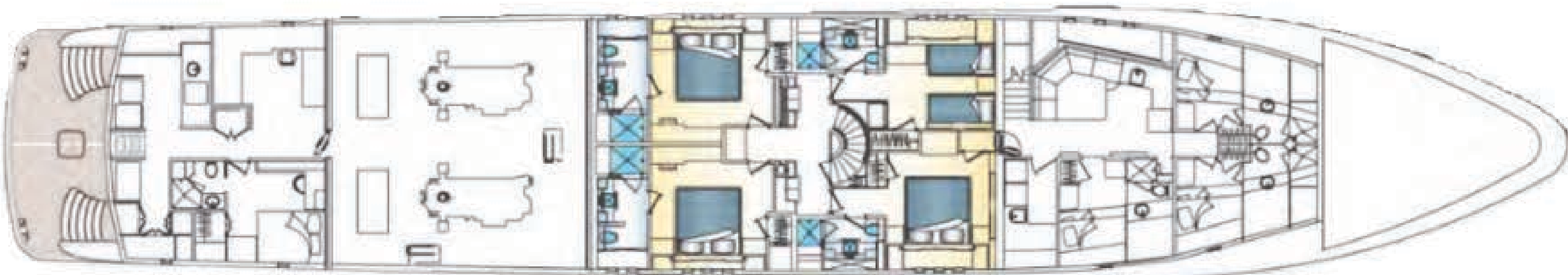

OCEAN CLUB

C O N T A C T Y O U R C H A R T E R B R O K E R