



Navilux

LUXURY MOTOR SAILER

OVERVIEW

Built in Croatia in 2012, Yacht "Navilux" is a premium motor sailer designed for private charters. It offers luxurious accommodations for twelve guests in 6 en-suite staterooms, with the Master cabin being a highlight. The yacht's social spaces are well-designed, with indoor and outdoor areas seamlessly connected. You can sunbathe, relax, or enjoy movies and games in the salon. The deck space is ideal for enjoying the sun and scenic views. The aft deck accommodates alfresco dining for twelve guests, and the yacht provides various amenities for your comfort and joy, including a jacuzzi and a well-equipped bar.



SPECIFICATIONS

Accommodates	12 Guests in 6 Staterooms
Arrangements	5 Double, 1 Convertible Twin
Length	37.30m
Beam	8.30m
Draft	3.20m
Built	2012
Hull	Steel
Deck	Teak
Engines	2 x Doosan 265 kW / 360 HP
Electricity	12V / 24V / 220V
Air Condition	In all closed spaces
Generators	2 x Caterpillar 50kW
Cruising Speed	10 knots
Maximum Speed	12,5 knots
Crew	8
Cruising Area	Adriatic Sea

Navilux



KEY FEATURES

- **Cultural Elegance:** Navilux exudes luxury with Croatian and European-inspired design, creating an elegant, luxurious, and comfortable atmosphere.
- **Artful Interior:** Modern design with harmonious colors and lines transforms the yacht into a floating gallery, showcasing works by a distinguished Croatian artist.
- **Impressive Exterior:** Boasting large sunbathing areas, a jacuzzi, a bar, and ample space for activities, Navilux's exterior provides an inviting environment.
- **Luxurious Accommodations:** Impeccably furnished cabins for up to 12 guests, fully equipped with modern amenities, including en-suite facilities, plasma TV, safe, storage space, interphone, and room service.
- **Waterfront Oasis:** Relax with a bow jacuzzi, alfresco dining on the aft deck, and easy water access via a swimming platform, complemented by a tender boat and an array of water toys for entertainment.

Navilux



































WATERTOYS

- Ris Marine tender 6,5 m 150 HP,
- Personal watercraft (Sea-Doo Spark Trixx, 3 seaters) x 2,
- Seabob F5 x 2,
- Waterski for adults and children,
- Wakeboard,
- SUP board x 4,
- Kayak (2 seaters) x2,
- Inflatable towables,
- Snorkeling Equipment,
- Amateur Fishing Gear,
- Floating Mats,
- Foam Floating Tubes,
- Floating dock.

Navilux



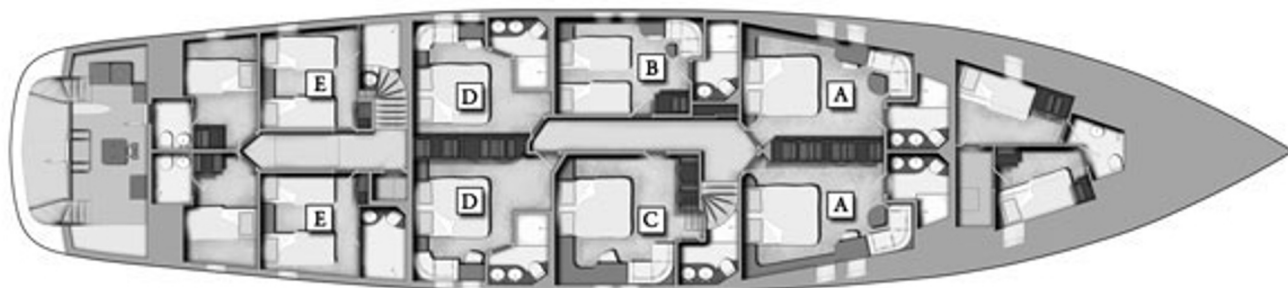
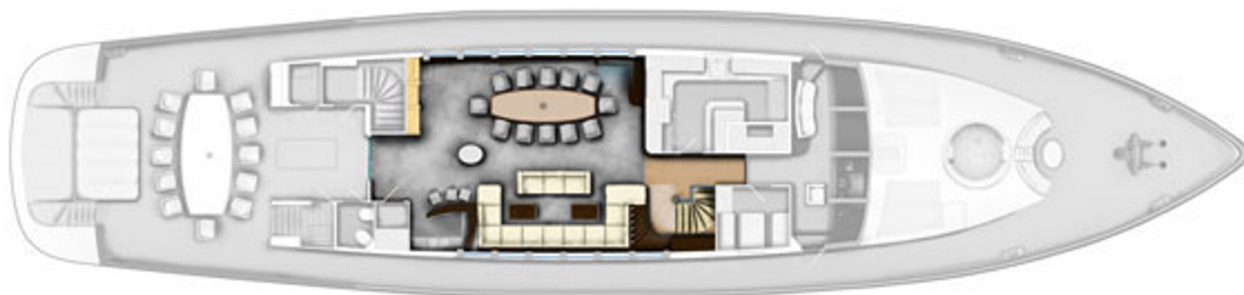
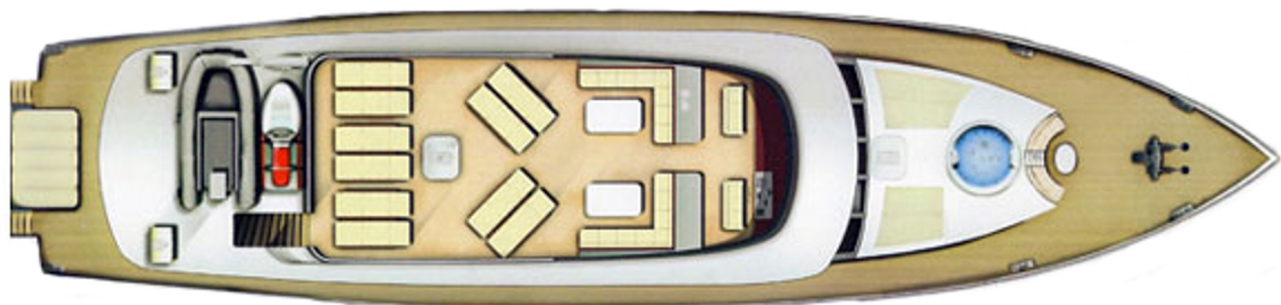

"Navilux Team!!

Thank you so much for such an incredible week! You all work so hard, and most of it doesn't even get noticed! All your work is what makes guests hang onto every last moment aboard. All the water toys and food also added so much! I will miss this so much! Thanks again!"

June, 2025

"Thank you to the amazing Navilux Crew. Our week with you has ruined all future holidays. Nothing will compare to this magical week. Thank you for the immense amount of patience with our children, for waking up early and fishing, playing hide and seek, and taking us to collect the lobster. We will be back! P.S. Thank you for the 365 appearance."

July, 2025



Navilux

LUXURY MOTOR SAILER