

E-BROCHURE

Life Saga





LIFE SAGA is a 65m superyacht from Admiral, delivered in 2019 with only very light private use since, and won the prestigious Motor Yacht Over 60 Metres award at the International Yacht & Aviation Awards. Her bold design and seamless indoor-outdoor living create a refined setting for 12 guests, offering complete comfort and the freedom to explore in style.





LIFE SAGA



MAIN DECK INDOOR/OUTDOOR SALON



MAIN SALON



MAIN DECK MAIN SALON

The interiors of LIFE SAGA, designed by Mark Berryman, carry a subtle Japanese influence. Natural materials such as oak, walnut and teak combine with soft cream furnishings, rich leathers and bronze accents to create a serene, elegant setting. Floor-to-ceiling windows fill the space with light and maintain a constant connection to the sea.



MAIN DECK



MAIN DECK MASTER SUITE





VIP CABIN ENSUITE BATHROOM

Accommodating up to 12 guests in six luxurious cabins, LIFE SAGA includes a full-beam Master suite on the main deck with panoramic views, a private lounge, office and marble bathroom. Additionally, she features a spacious VIP cabin on the upper deck, two elegant doubles on the main deck, and two convertible doubles on the lower deck.



VIP CABIN ON UPPER DECK



DOUBLE CABIN ON MAIN DECK



CONVERTIBLE DOUBLE ON LOWER DECK



UPPER DECK AFT



DINING AREA ON UPPER DECK



UPPER DECK AFT

The upper deck boasts a spacious lounge with modular seating, a formal dining table for 12, and an elegant sky lounge with bar and generous sofas. Up on the magnificent sun deck, guests can enjoy a wet-bar mosaic pool, a generous outdoor lounge area, a large jacuzzi surrounded by sun pads and a fully equipped kitchen with Teppanyaki station and bar.



UPPER DECK AFT



UPPER DECK SALON



WELLNESS CENTRE ON LOWER DECK



At water level, the beach club with fold-out terraces on three sides, provides guests with the ultimate wellness space for spa treatments and workouts. The spa facilities include hammam, sauna, mood shower and a large jacuzzi, complemented by a wellness area where guests can enjoy massages or workouts with direct access to the water.





BEACH CLUB



SUN DECK FORWARD

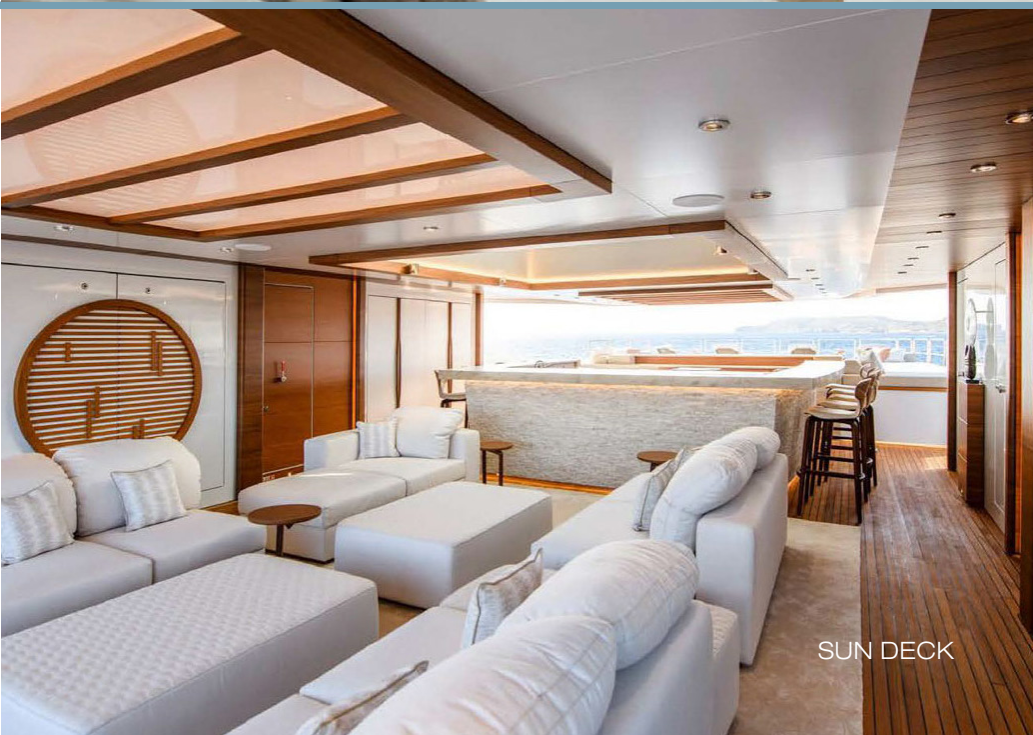



SUN DECK AFT



SUN DECK AFT



LIFE SAGA's four expansive decks offer sunbathing areas, jacuzzis, open-air dining spaces and panoramic lounges. The beach club features fold-down terraces extending over the sea, a shaded lounge by the water and an integrated swim platform providing effortless access to an array of water toys and tenders.









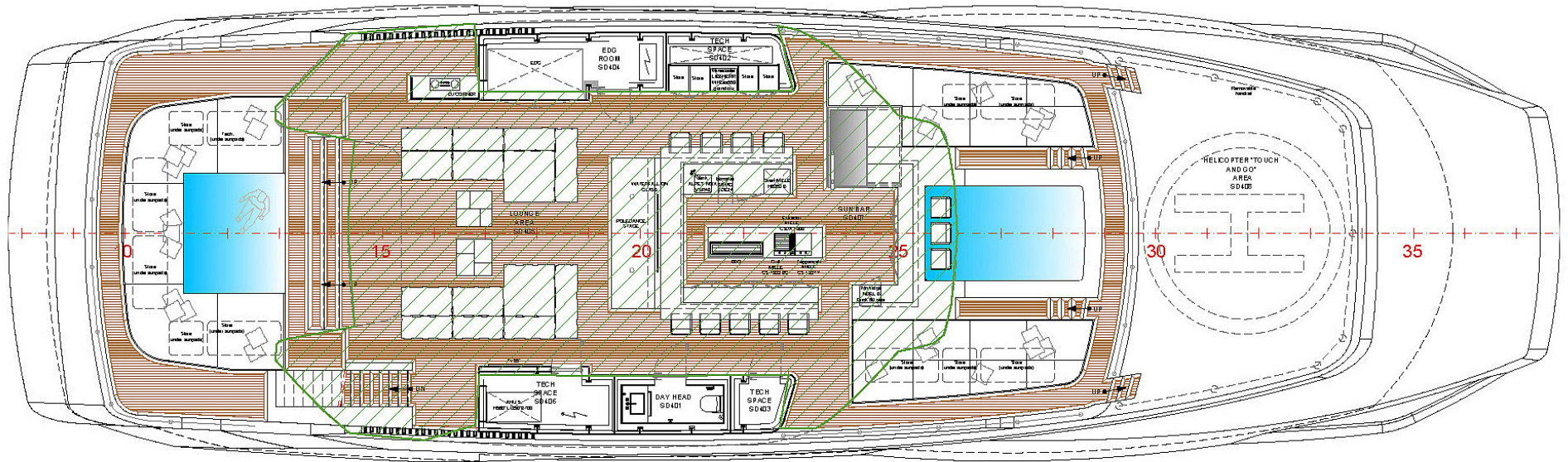

SUN DECK

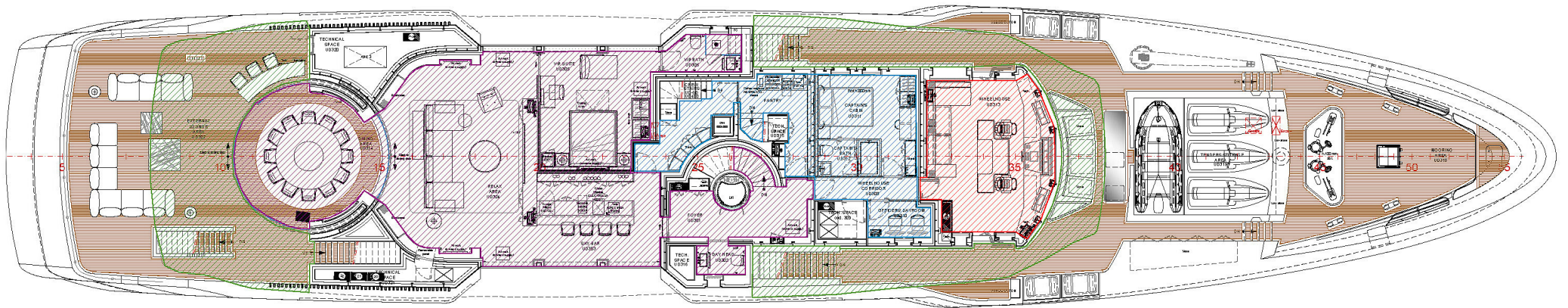

UPPER DECK

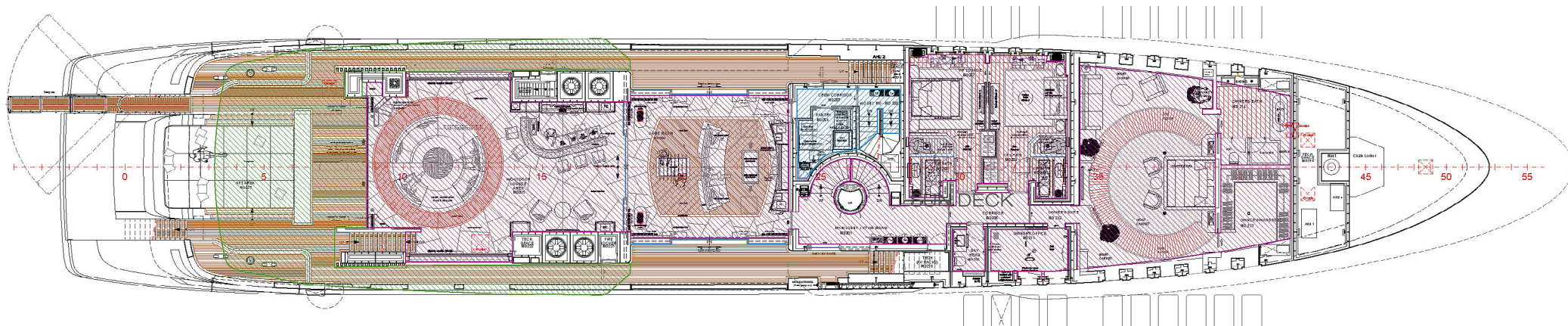

MAIN DECK

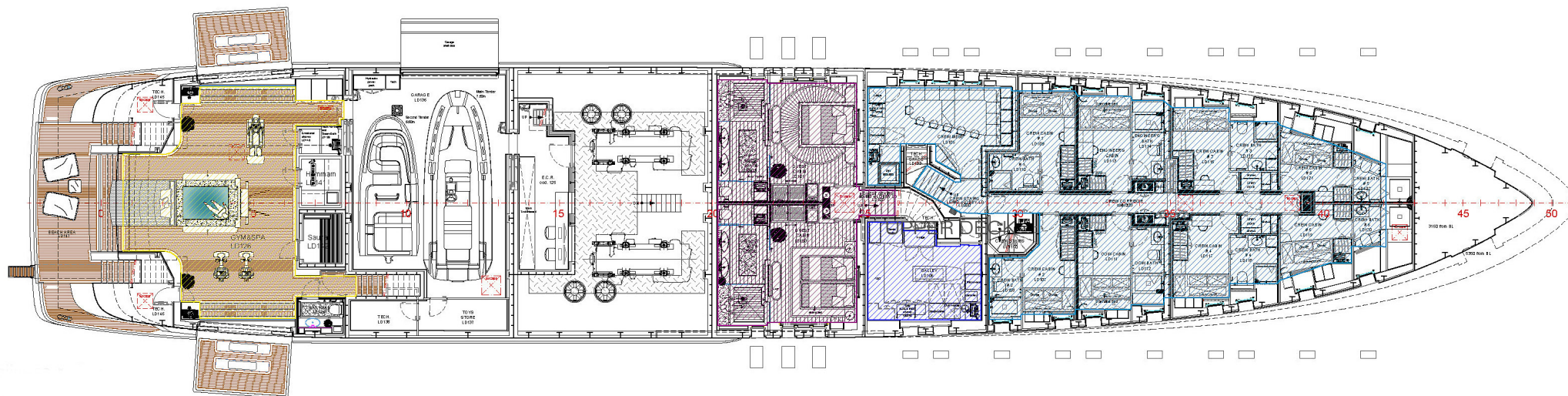

LOWER DECK



SPECIFICATIONS

MAIN CHARACTERISTICS

Length: 65.23 m (214')
Beam: 10.60 m (34' 9")
Draft: 3.05 m (10')
Year: 2019/2025
Builder: Admiral
Interior Designer: Mark Berryman Design
Accommodation: 12 guests
Cabin Configuration: 4 Double, 2 Convertible (6 king beds)
Total Guests Sleeping: 12 guests
Total Guests Cruising: 12 guests
Cruising speed: 13 knots
Max Speed: 15,5 knots
Fuel consumption: 500 Litres/Hr (cruising)
Zero speed stabilizers - Stabilisers underway and at anchor

TENDER

1 x 7.4m Ribeye Tender
1 x 6.2m Ribeye Tender

TOYS

3 x Seadoo jet skis
1 x Flite board 100
1 x Jobe wakeboard
2 x Wake surf boards
2 x Rigid paddle boards
1 x Inflatable paddle board
2 x Rigid Kayaks
Tow toys (Banana, flyer/donut, sofa)
Beach toys (Bats & Balls, frisbee etc)
2 x F9 Seabobs (TBC)
Dive equipment (7 x people)
Snorkelling gear and fins

GYM EQUIPMENT:

Bosu Ball
Rowing machine
Technogym weights
Technogym bench
Foam roller
Peloton Bike
Peloton mat
Resistance bands
TRX straps
Yoga mats

KEY FEATURES:

1. Multi award-winning yacht.
2. Incredible volume makes it feel like a much larger yacht
3. Stunning beach club with spa pool, built-in sun pads and a sauna
4. Spectacular double-height glass windows for uninterrupted views
5. Retractable glass partitions blend indoor and outdoor areas beautifully
6. Asian-inspired interior designed by Mark Berryman
7. Ideal for those looking to enjoy wellness at sea

Advertising of the above vessel in either printed publications on the internet or in any other medium is not permitted without prior permission from the Owner via the Central Agent.

All particulars are given in good faith and are believed to be correct but cannot be guaranteed.