

LADY BRITT



FEADSHIP
ROYAL DUTCH SHIPYARDS

The ultimate charter yacht

While many superyachts are built with chartering in mind, the owner of *Lady Britt* gave priority to offering the ultimate charter experience. This reflected the fact that he still worked full-time and would not spend sufficient time onboard to justify keeping a *Feadship* all to himself. And so the design and layout experts at *Feadship* partnered with the owner and his highly experienced captain to create *Lady Britt*, a yacht that caters to every possible wish of all who step aboard.

From the panoramic gym on the sun deck to the multi purpose aft deck that allows access via a central staircase to the ocean, from the outdoor cinema to the immense suitcase storage area, from the authentic Finnish sauna with private access to the ocean to a galley with steam ovens, attention to detail is combined with a passion for relaxation and comfort.

Lady Britt also sees *Feadship* setting new standards when it comes to ensuring a yacht meets the everyday operational aspects of a charter. For instance, the intuitive controls for the entertainment system are simple for guests to use while an on-screen *Yacht Eye* system features a 3D model identifying the surrounding buildings and indicating where the yacht is heading next. The ship's channel displays photos of the previous day's fun, the menu for the day, and so on. Other highlights that make for the most memorable of holidays are temperature-controlled storage for four hundred wine bottles and the most comprehensive selection of watersport toys imaginable.

Logical and elegant, perfectly crafted and a great experience in every way... Meet the lovely *Lady Britt*.





Day and night

It is no secret that guests usually choose to spend the majority of their time enjoying the alfresco life when staying on a Feadship.

Lady Britt takes this fully into account. The sundeck [1], for instance, is a self-contained zone for the entire day, with a shower and day head integrated into the superstructure,

a food lift, wine provisions and a bar. The outdoor pleasures can continue well after sundown as a Creston AV projector and speakers descends from the ceiling on the aft deck to create a splendid cinema environment. Additional satellite speakers can also be plugged in for larger groups,

while the sun pad doubles as a DJ station or bandstand. Sliding glass doors on all four sides of the sun deck indoor bar open up to generate a unified indoor/outdoor space.





Cosy comforts

The bridge deck lounge [6] is an exceptionally cosy place. As lunch and dinner are often served out on the bridge deck aft [5], this lounge is a favourite spot for aperitifs at the bar, which includes a draft beer tap. While the primary indoor movie screen is on the main deck, the painting here also lowers to reveal a large TV. Much of the furniture onboard *Lady Britt* is custom-made by UK company SilverLining to an exceptional quality standard. Examples in this lounge include the detailed workmanship of the coffee table and the exquisite games table. The lounge also features what some guests have described as 'the most comfortable couch in the world' from Dudgeon's workshops in London.





Al fresco arrangement

Another splendid area for relaxation is the expansive bridge deck aft [5]. An al fresco arrangement highlights the amount of space, with couches and chairs to starboard and port. A 50-inch TV is available to check the markets and can pivot round to allow viewing from the seats or dining table. The whole area is serviced by a spacious pantry with wing doors to port and starboard - one of many ways in which the captain's practical experiences have been incorporated. A crew stairway stretching from the back of the bar on the sun deck down to the main deck pantry further facilitates the behind-the-scenes logistics. And if guests really want to get away from it all, they can opt for the snug seating alcove forward of the wheelhouse [13].





15

Artful touches

Lady Britt's warm interior features lots of Macassar Ebony and fine detailing, as is apparent here in the main deck lounge, corridor and stairs. The yacht's entry foyer [17] has been made deliberately wide to create a welcoming meet & greet zone for

when guests first step aboard. From there they can be guided to the guest rooms below, the Owners' stateroom forward [19] or into the main lounge deck [15] for their first taste of the luxury life. The latter is one of many areas to benefit from the owner's love of art,

which sees works by Henry Moore, Picasso, Chagall and others on display around *Lady Britt*. Visual art of a different form is available at a click of a switch as the blinds close and a projector lowers to create a cinema.



17

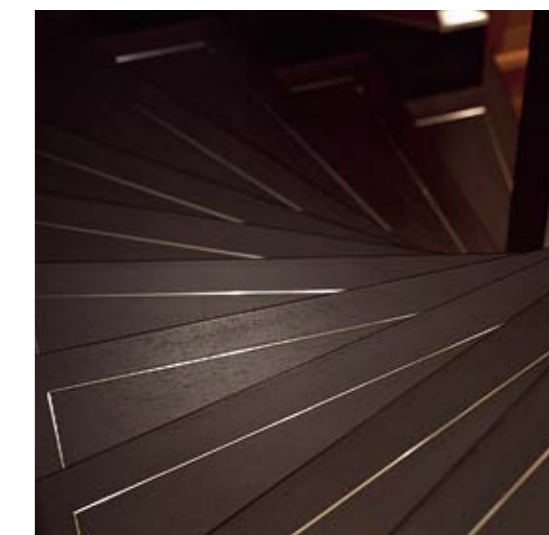



16

Service class

Lady Britt's gorgeous dining room [16] features a table made of Macassar Ebony and Elm Burl. This extends to seat fourteen people plus classic brown leather chairs handmade by Peter Dudgeon. The classy feel is accentuated by the intricate overhead lighting, a fine Chagall on the wall and a luscious Tai Ping carpet. A clever system

is in place to ensure the ambience is not disturbed as crew are serving. A sensor dims the lights and turns off any music in the galley [18] before the access door from the pantry to the dining room opens. Incidentally, the pantry here contains a fresh filtered coffee machine and one of many EuroCave wine cabinets.

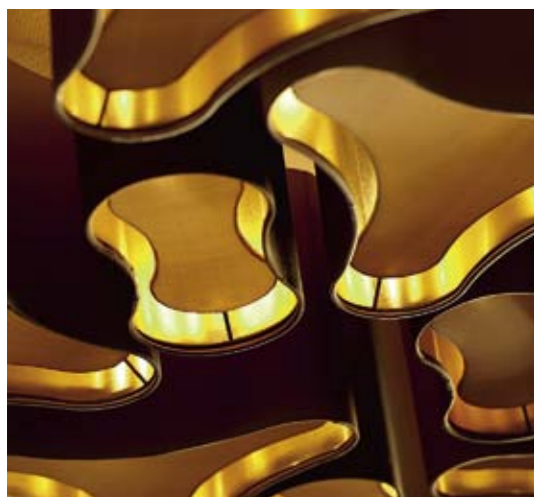

Where would you like to sit?

The main deck aft [14] is the stage and setting for a characteristically warm welcome on to *Lady Britt*. The same quality and attention to detail seen throughout her interior is subtly showcased here. A comfortable

seating area can be dressed for more formal occasions, while its layout and appointment are just as easily adapted to relaxed informal gatherings.





LADY BRITT



19



20

Hidden treasures

Smart thinking also abounds in the full beam owners' stateroom [19], which has a luxury New York apartment feel, including separate his & her bathrooms and dressing rooms. The starboard section can be closed off to create an office [20], yet the stateroom still has lots of space and is positively expansive as a full beam apartment. There is also an additional room that can be locked to house the owner's personal pieces during charter bookings: A hidden door to the corridor means guests will not even be aware of its existence.





22

Master bathroom

Top-of-the-range superyachts normally feature six or seven marbles - *Lady Britt* has over twenty different types onboard, all hand selected in Carrara by the owners. They have a keen eye for splendour as you can see here in the two master stateroom bathrooms [21, 22], each of which are entirely customised his & her affairs. The latter, for

example, has a fabulously comfortable bath in which to relax against a head rest watching television. 'His' has a different sort of screen, allowing the yacht's key systems to be followed via Furuno. Both bathrooms have teak grills in the showers to give an extra air of refinement and both offer wonderful scenic views through the windows.



21



28

Maximum flexibility

Lady Britt has six Anigre-panelled guest suites on the lower deck, two of which can be combined to create a large, full-beam VIP stateroom (a crucial asset for the increasingly frequent dual-principal charter groups). The couch in the lounge is designed as a bed that converts into a couch and not the other way round, so when all six suites are used the comfort levels remain phenomenal. The freestanding chairs allow for a lounge feel or can be moved out in the two-suite configuration. Even the Creston lighting system has been specially programmed in order to adapt to a VIP stateroom [28] or two suite set-up. Nothing is left to chance on *Lady Britt*.



27



34



31



39



First impressions count

A phenomenal corridor awaits the guests who descend to the lower deck, showcasing the length of the boat and ensuring that charter guests also feel very spoiled even if not residing on the main deck. The four other guest suites are flexible enough to cater for almost any group arrangement. There are two twins forward, both with expansive bathrooms, one with a walk-in closet. The two doubles amidships each have their own seating area, with the port bathroom having a bath and the starboard a huge walk-in shower.



36



35



3



9



9

Looking good, feeling good

One of the most impressive facilities on the sun deck is the gymnasium [3], which features a range of specialised equipment that includes individual television and iPod connections. The views over the foredeck while working up a sweat are superlative and will surely encourage fitness seekers to literally and metaphorically go that extra mile. For those who prefer relaxation of a more sedentary nature, *Lady Britt* also houses a dedicated wellness and massage

spa [9] on the bridge deck that doubles as a hairdressing saloon and beauty parlour. This self-contained space includes underfloor heating and a pivoting massage table. The room can also function as a hairdressing saloon or beautician's parlour, complete with 'candle' holders for incense sticks and aromatic reeds that meet fire regulations. It is, needless to say, truly exceptional for a 63-metre yacht to have such facilities onboard.



The heat is on

Although, as we have seen, charter guests are a key consideration onboard *Lady Britt*, her owner's specific desires are also very well catered for. The dimensions of this delightful Finnish sauna [25], for example, have been calculated to ensure that he can

read the *Financial Times* in comfort. Other guests can also enjoy this authentic hotspot as the seating can be rearranged into various configurations. To allow people to enjoy a plunge pool effect, a hatch on the side of the vessel folds down, complete with its own

ladder and shower. This means that other members of the party can still enjoy the toys and the swimming platform at the stern while allowing sauna guests to take to the water in safety. There are also drinks facilities and a day head in this self-contained area.





Playtime

The layout and service logistics ensure that guests cherish the memories of their time onboard *Lady Britt*. This starts the moment they step aboard, especially perhaps when arriving by tender and alighting the beautiful stern stairs to the expansive aft deck. *Lady Britt* carries two fabulous custom tenders (launched via giant gull-wing doors), waverunners, laser sailing dinghies, scuba gear and many other watersport toys. Her fold-down swim platform is finished in varnished wood to reinforce the beach house style.





Food for thought

The ability to serve haute cuisine is a vital part of any Feadship and in *Lady Britt's* galley [18] every conceivable request has been considered, ranging from steam ovens for the health-conscious to deep fat fryers for the hungry. This impressive space has been designed with dedicated positions for

the Michelin-star chef plus a specific food preparation area separate from the interior team. Clear lines of sight and communication are factored in so that the galley team can truly keep their eyes on the prize of serving the tastiest dishes imaginable.



Technical specifications

Year	2011
Builder	Feadship
Type	Twin screw motor yacht, steel hull and aluminium superstructure
Length overall	63.00 m / 206'8"
Beam overall	11.30 m / 37'1"
Draft (loaded)	3.50 m / 11'6"
Fuel capacity	148,700 liters / 39,265 US Gallons
Fresh water capacity	38,500 liters / 10,165 US Gallons

Design	
Naval Architect	Feadship De Voogt Naval Architects
Exterior styling	Feadship De Voogt Naval Architects
Interior design	Redman Whiteley Dixon
Propulsion	
Main engines	2x MTU 16V4000 M61R, 1520 kW @ 1600rpm
Max. speed appr.	16 knots
Range:	5,500 @ 12 knots



12



SUN DECK

1. Sun deck aft
2. Sun deck bar
3. Gym
4. Jacuzzi

MAIN DECK

14. Main deck aft
15. Main deck lounge
16. Dining
17. Main deck entrance
18. Galley
19. Owners' stateroom
20. Owners' office
21. His bathroom
22. Her bathroom
23. Tender garage

LOWER DECK

24. Beach platform
25. Finnish sauna
26. Swimming platform

BRIDGE DECK

27. Guest bathroom
28. VIP stateroom
29. Guest stateroom
30. Guest bathroom
31. Guest stateroom
32. Guest bathroom
33. Guest bathroom
34. Guest stateroom/VIP lounge stateroom
35. Guest stateroom
36. Guest bathroom
37. Guest stateroom
38. Guest bathroom
39. Guest hall
40. Laundry
41. Crew lounge
42. Crew cabins

Exploring this brochure: the numbers on the general arrangement plans correspond with those given in the text and photographs.

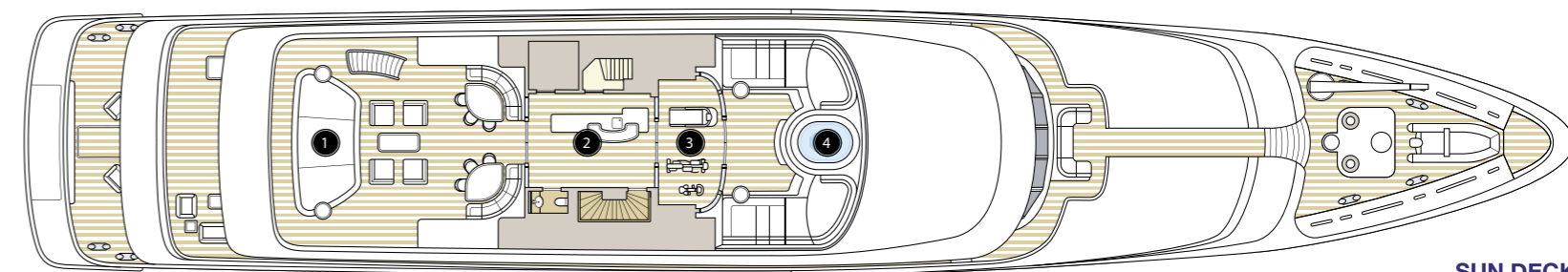

SUN DECK

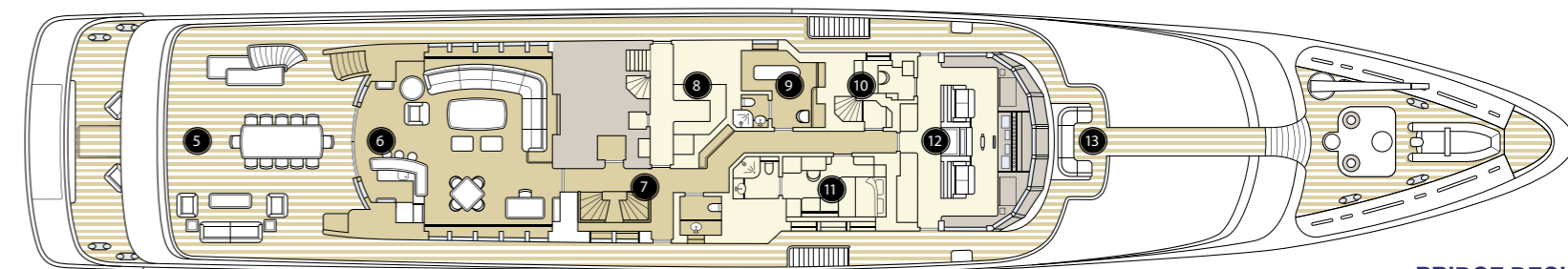

BRIDGE DECK

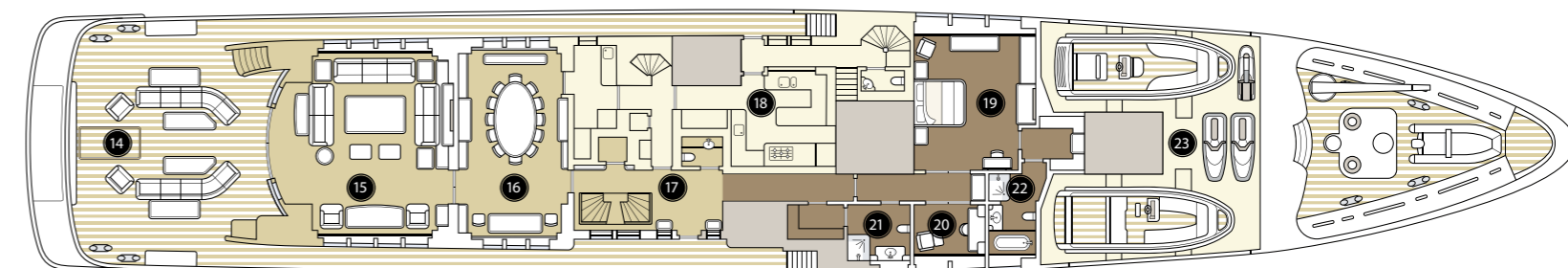

MAIN DECK

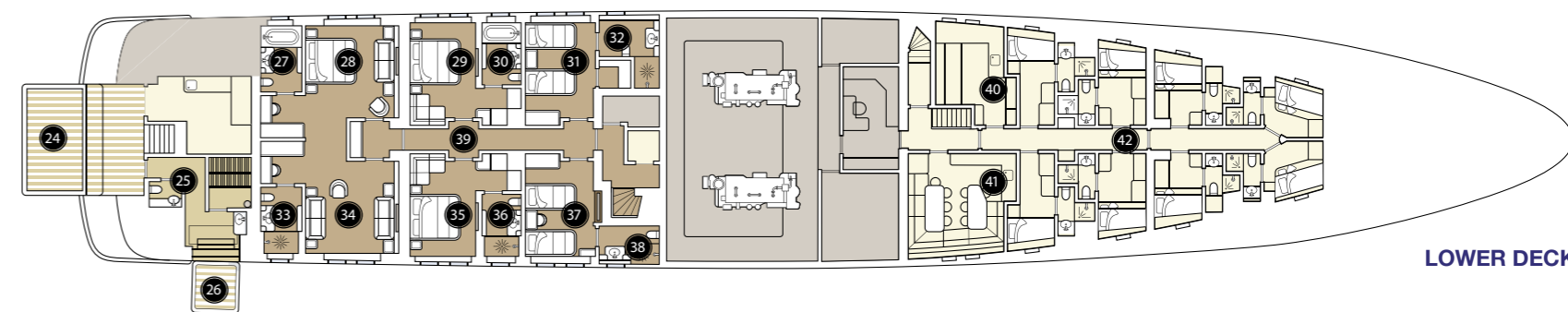

LOWER DECK

GENERAL

OWNER

GUEST

CREW

TECHNICAL