

MY GREY

50 m (163'4") | Tankoa Yachts | May 2023



BUILDER

Tankoa Yachts

YEAR

May 2023

LOA

49.9 m

BEAM

9.4 m

DRAFT

2.4m

GUESTS

12

CABINS

6

CRUISING SPEED

14 knots

MAX SPEED

17 knots

STABILISERS

CMC

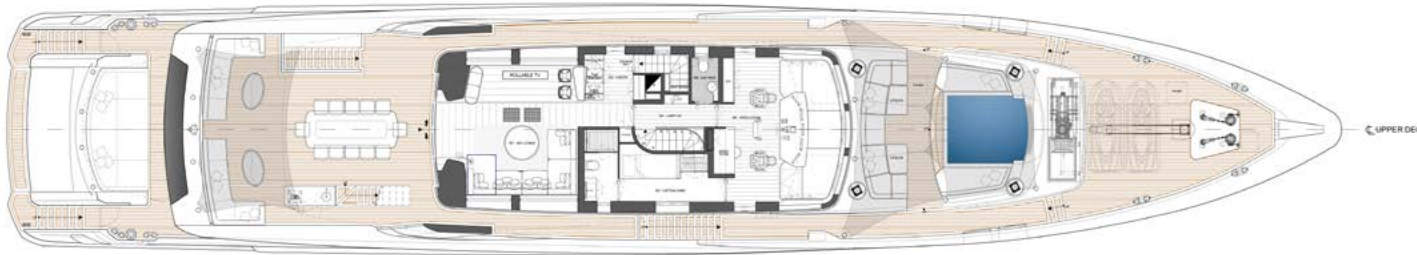
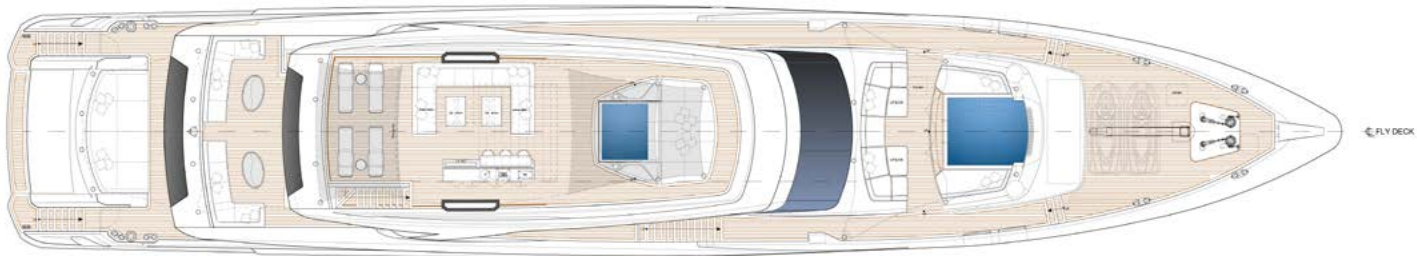

ABOUT GREY

Launched in 2023 by Tankoa, GREY has a distinctive sleek shape, with a “whisper grey” hull and a “jet black” superstructure designed by Francesco Paszkowski and a chic interior by Cassetta Yacht Designers. She enjoys impressive speed and seaworthiness, whilst her low draft allows her to access shallow areas and cruise close to shorelines.

GREY has expansive interior spaces and focuses on delivering the ultimate in comfort and entertainment for her guests, from spacious staterooms with large beds, extra soft sun loungers to the very latest in entertainment screen technology. On her foredeck, GREY displays a show-stopping Cseed foldable external 144” Cinema TV, where you can have a truly cinematic experience whilst relaxing in the Jacuzzi. There is also an LG 65” signature rollable TV in the upper lounge and a 55” screen in the Master stateroom.

With a pool forward and a large Jacuzzi on the sundeck, Grey offers guests a choice of five outdoor spaces, spread over 300 square metres of deck, to dine or relax on.

Up to 12 guests can be accommodated in 6 spacious and modern staterooms, each with ensuite. The magnificent, full beam master stateroom features an emperor sized bed (200 x 200 cm), ensuite bathroom, walk in closet, office space and two fold-out verandas opening up on either side of the boat allowing you to watch the sunset wherever you anchor. A large VIP stateroom can also be found on the main deck, whilst 2 further doubles and 2 twin/double convertible staterooms, all with their own 43” TVs and ensuites are located on the lower deck. The latest in Starlink and 5G means guests will have access to great WiFi and media throughout.

KEY FEATURES

- 2 x on deck jacuzzis: an open air jacuzzi on the foredeck for 8 guests and a shaded bubble spa on the flydeck
- Magnificent, full beam master stateroom with emperor sized bed (200 x 200 cm), office space and two fold-out verandas
- Cseed foldable external TV 144” on the foredeck in front of jacuzzi offering cinematic experience
- LG 65” signature rollable TV in upper lounge
- Latest Starlink satellite system and 5G system onboard, allowing for superb WiFi internet and media
- Launched in 2023 she has impressive speed, seaworthiness and her low draft allows her to access shallow areas and to cruise closer to shorelines

ACCOMMODATION

Number of Guest Cabins: 6

Guests: 12

Sleeping Configuration: MAIN DECK
Full-beam master stateroom, with large king bed (200 x 200cm) and 55" TV, with two opening balconies, allowing you unparalleled access to the view wherever the sun sets or rises. A double sink ensuite bathroom, seating area and separate office space and walk in closet. VIP double stateroom with king bed (180 x 200 cm), situated to the fore of the yacht behind the master stateroom, a 43" TV and seating area and an ensuite bathroom and closet.
LOWER DECK
2 x guest double staterooms each with a king bed (180 x 200cm), 43" TV, closet and an ensuite bathroom. 2 x convertible twin staterooms, each with the ability to combine the twin beds (85 x 200) to make a queen double with 43" TV, closet and ensuite shower-rooms.

GYM EQUIPMENT

- # Techno Gym Bench
- # Techno Gym Exercise Bike
- # Dumbbell Weights
- # Yoga Mats

AV EQUIPMENT & OTHER FACILITIES

- Jacuzzi on the foredeck accommodates 8 people
- C Seed foldable external Cinema TV 144" on the foredeck in front of Jacuzzi
- AV/IT is controlled by Crestron in all the areas, sound systems are FOCAL
- TV 65" LG signature rollable TV, in upper lounge
- Access to Netflix, AmazonTV, Spotify connect, Apple TV & Airplay, worldwide radio available.
- 2 x Marzocco coffee machines or coffee lovers
- BBQ on the fly deck
- Internet with WiFi via:
STARLINK (2 x Starlink Antennas)
4G/5G WiFi (where available)

TENDERS & TOYS

- Williamson 5.65m 195hp
- Sea-Doo Jetski 230hp 2023
- Seabob F5S
- Liftfoil
- 2 x Standup Paddle Boards
- 2 x Inflatable Canoes
- Jobe Roamer (2 person)
- Jobe Sonar (2 person)
- Jobe Air Head
- Sports Stuff Big Mable (2 person)
- Waterskis
- Kneeboard
- Wakeboard





Profile





Profile





Profile



Upper Deck



Upper Deck



Upper Deck



Upper Deck



Profile



Upper Deck



Upper Deck



Fly Deck



Garage

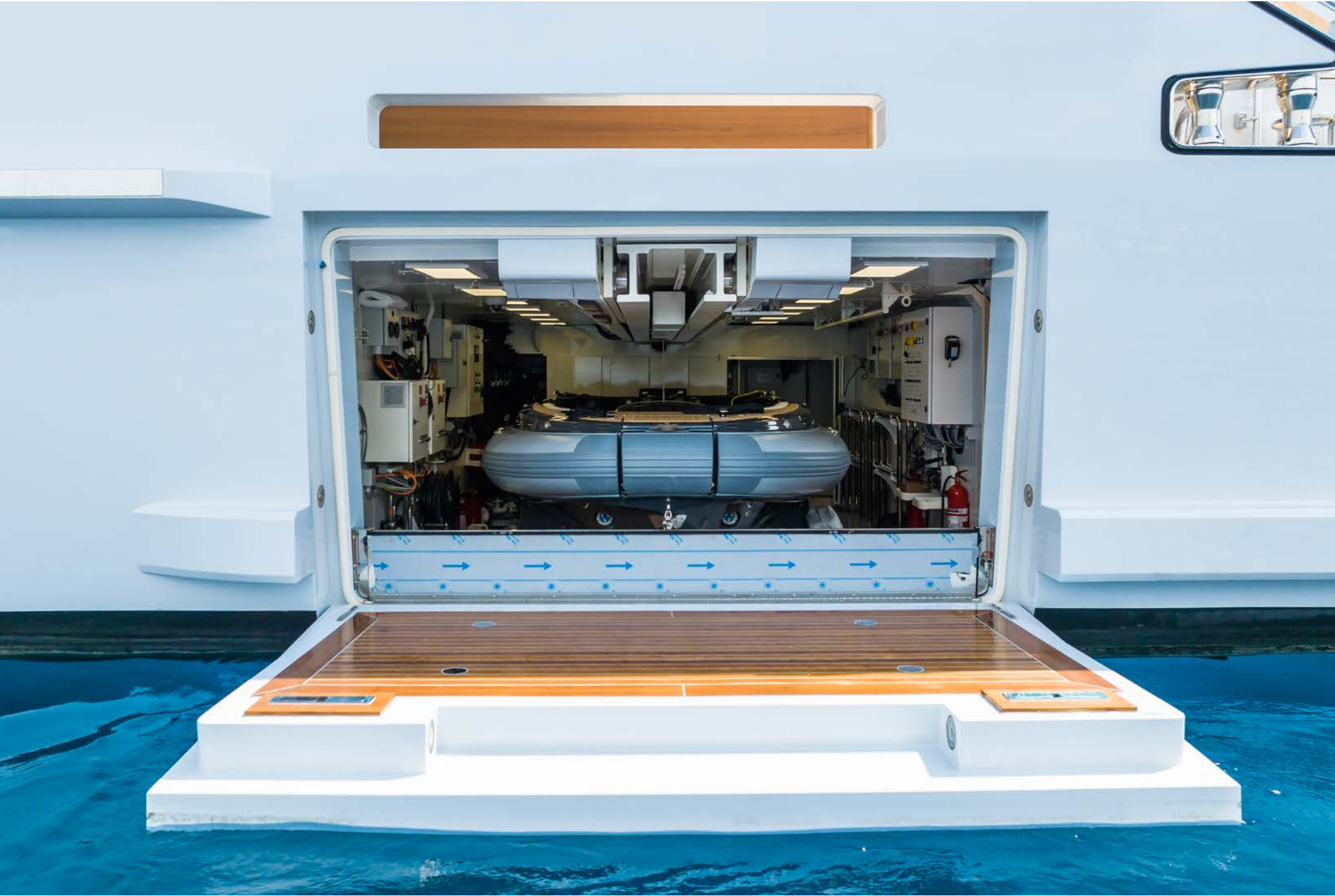

Garage



Beach Club



Main Saloon



Main Saloon



Main Saloon



Dining



Main Saloon



Main Saloon



Sky Lounge



Sky Lounge



Sky Lounge



Sky Lounge



Owner Cabin



Owner Cabin



Owner Cabin



Owner Cabin



Owner Cabin



Owner Cabin



Owner Cabin



Owner Cabin



Owner Cabin



Owner Cabin



VIP Cabin



VIP Cabin



VIP Cabin



VIP Cabin



VIP Cabin



Guest Cabin



Guest Cabin





