

GALAXY



56 METER BY BENETTI





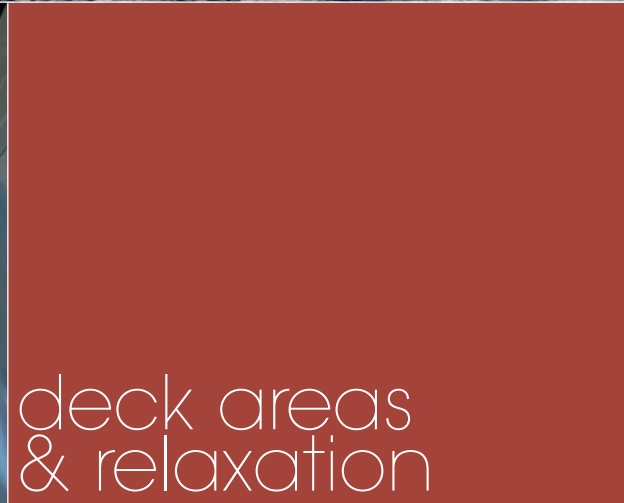
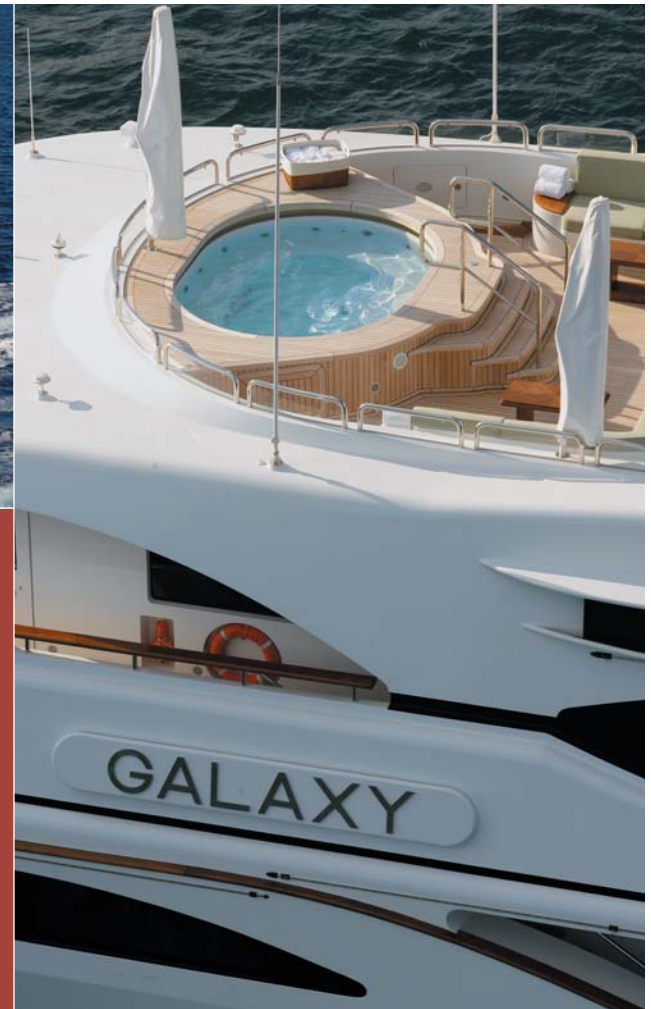







upper saloon





main saloon









master stateroom

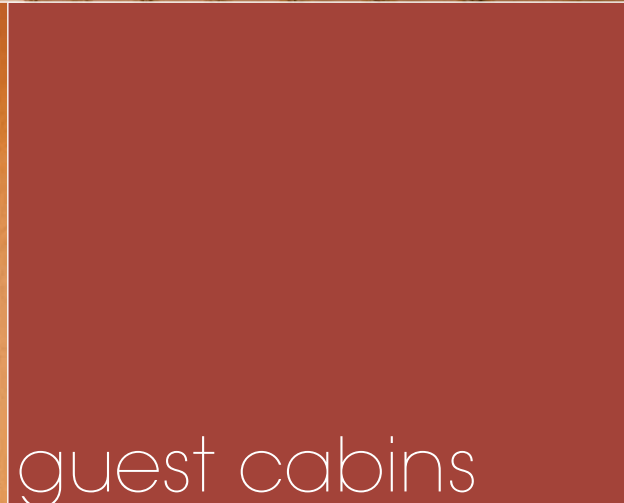



SPECIFICATIONS

BUILDER	BENETTI, ITALY
YEAR	2005
LENGTH	56m/184'
BEAM	10.4m/34'
DRAUGHT	3.1m/10'
ENGINES	TWO CATERPILLAR 3512B
SPEED	MAXIMUM: 16 KNOTS CRUISING: APPROX 15 KNOTS
FUEL CONSUMPTION	430 LITRES P/HR, INCLUDING 1 GENERATOR
RANGE	5,000 NM
STABILIZERS	NON-RETRACTABLE VOSPER FINS
CREW	15

ACCOMMODATION

GALAXY has a glass cabin elevator, linking the accommodation deck to the Main Deck, the Upper Deck and the Sun Deck. On the Sun Deck the elevator lands in the gymnasium.

The gymnasium is equipped with an exercise bicycle, running machine and free weights.

And step machine cross trainer.

The yacht accommodates up to twelve guests in six ensuite staterooms.

The Owner's stateroom on the main deck, there are two doubles and two twins on the lower deck, and the VIP cabin is on the bridge deck.

All accommodation is fully air-conditioned. The Owner's stateroom has a king size bed, and his and her bathrooms, port and starboard. Stairs lead upwards to the Owner's private panoramic sitting room, with views forward. The main saloon comprises a large seating and relaxing area, with a formal dining room forward. There is a full width upper saloon with bar, and a circular "verandah" style dining area.

COMMUNICATION

Galaxy has global satellite communication comprising of 3 independent systems which enables 4 voice lines, 2 voice over IP lines (making a total of 6 voice lines) 3 fax lines, one of which is being direct to the master cabin plus satellite internet at speeds of up to 1Gb download. There are also 3 cell lines for coastal use, one of which is a dedicated fax line.

LEISURE AND ENTERTAINMENT

All cabins and guest living areas have large plasma or flat screen TVs, and DVD players, with cinema quality sound. All cabins and guest living areas receive Sky TV (when in range) as well as terrestrial channels.

There is a wireless computer network, connected to the internet with 'at sea' reception.

The sundeck has a large Jacuzzi forward, with ample sunbathing and lounging cushions. There is a bar close to the Jacuzzi. On the after part of the Sun Deck there are a number of "Sutherland" chaises lounges.

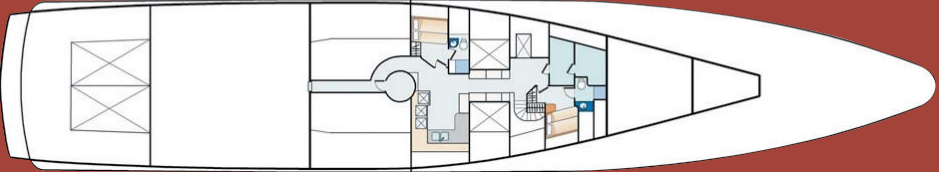
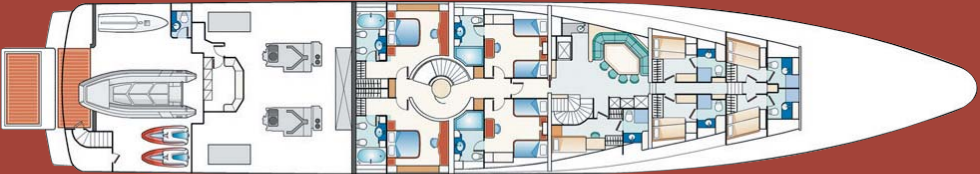
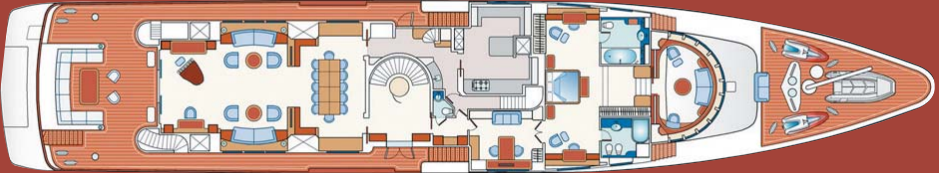
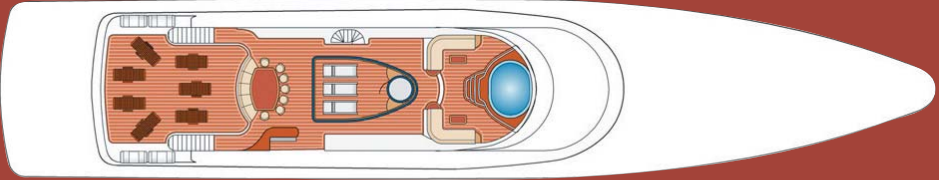

WATERSPORTS EQUIPMENT

- 1 Novurania 66DL Tender with twin Yamaha 90 hp outboards
- 2 GPR 900 Yamaha wave runners
- 2 Sunfish sail boats
- 6 sets of diving gear
- 2 2 person ocean kayaks
- 2 donuts
- 1 5 person Banana
- 1 pair professional skis
- 1 pair of amateur skis
- 1 knee board
- 1 wake board
- 1 windsurfer
- Floating trampoline



specifications



