

Chevy Toy







WELCOME ABOARD CHEVY TOY

The beautifully-appointed 142' (43.28m) Trinity yacht, offers the perfect yachting vacation. Whether you laze away your day basking on one of the Sundeck's chaise lounges or try out the impressive inventory of watersport equipment, relaxation is the key to the enjoyment of your time aboard CHEVY TOY. The owner's years of yachting experience are obvious in the accommodations and seamlessly designed interior. A décor of rich, neutral tones throughout the yacht is complemented by lustrous African cherry and sumptuous marble and nicely contrasts the exterior spaces' bright, festive colors. All this ensures that no matter where you spend your time on board, you'll be surrounded by comfort and fun.













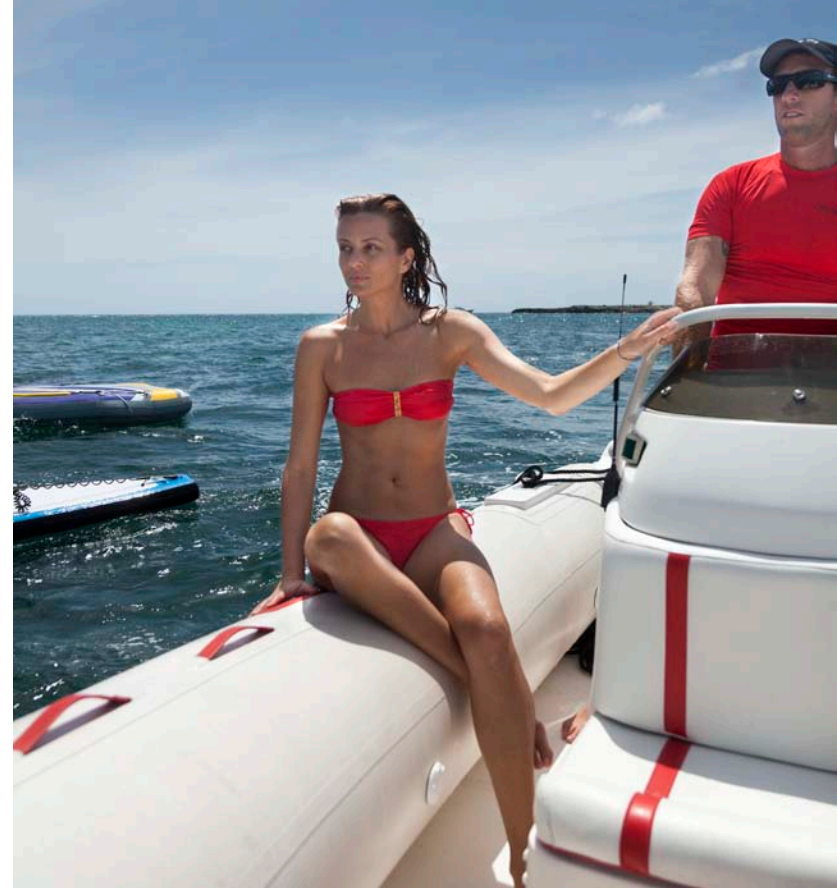

UPPER AFT DECK



MAIN AFT DECK



At the highest level of the yacht, you'll find the Sundeck. In addition to panoramic views and an expansive space to spend the day, this deck features a large raised Jacuzzi forward surrounded on three sides by bench seating, four chaise lounges, and, under the shade of the radar arch, a wet bar with five stools and a day head. If you would like additional shade, up to three awnings can be added. Finish off your day in the open air, with a meal on either the Main or Upper Aft Decks. The Upper Aft Deck offers seating for more than ten guests at three tables.



SUNDECK







The open-plan Main Salon and Dining Salon on the Main Deck is designed with more formal occasions in mind. Elegant china and crystal enhance the culinary delights prepared by the yacht's experienced chef. Silver service by the attentive interior staff sets just the right tone for a gracious evening complete with music from the baby grand piano. Welcome your guests aboard via the Main Aft Deck which also serves as the seating area for casual breakfasts, and can even be air conditioned when the optional eisenglass panels are lowered. A day head and central staircase are located in the foyer, which leads to the Master Suite.

DINING SALON





MAIN SALON









UPPER AFT DECK

UPPER AFT DECK



Three distinct areas make up the Upper Deck. Sit with the captain on one of the two bench seats in the Pilothouse or relax in the Skylounge, one of the yacht's most popular areas. The Skylounge is furnished with a wet bar with three stools which features a back lit white onyx bar top. Watch movies on the large screen TV via the central Kaleidescape A-V system with surround sound and iPad controls. On the Upper Aft Deck, enjoy dinner alfresco at a circular table for ten or recline on the large built-in sofa where two cocktail tables provide a picture perfect setting for pre-dinner drinks under the stars.

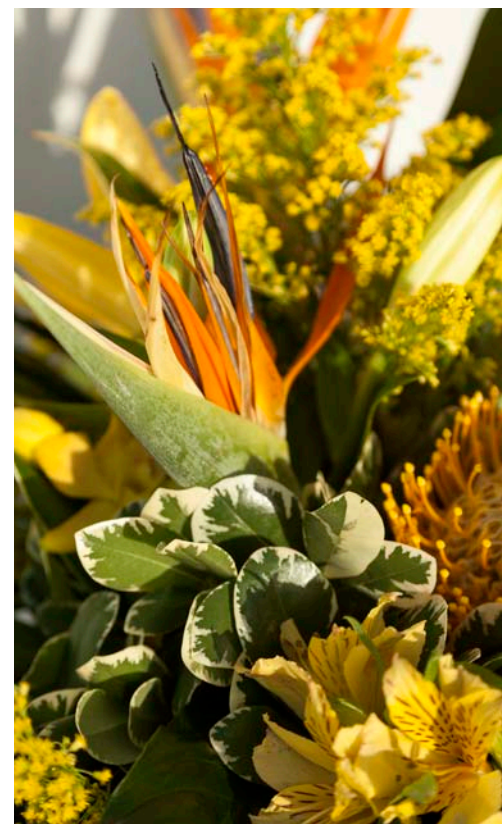



PILOTHOUSE



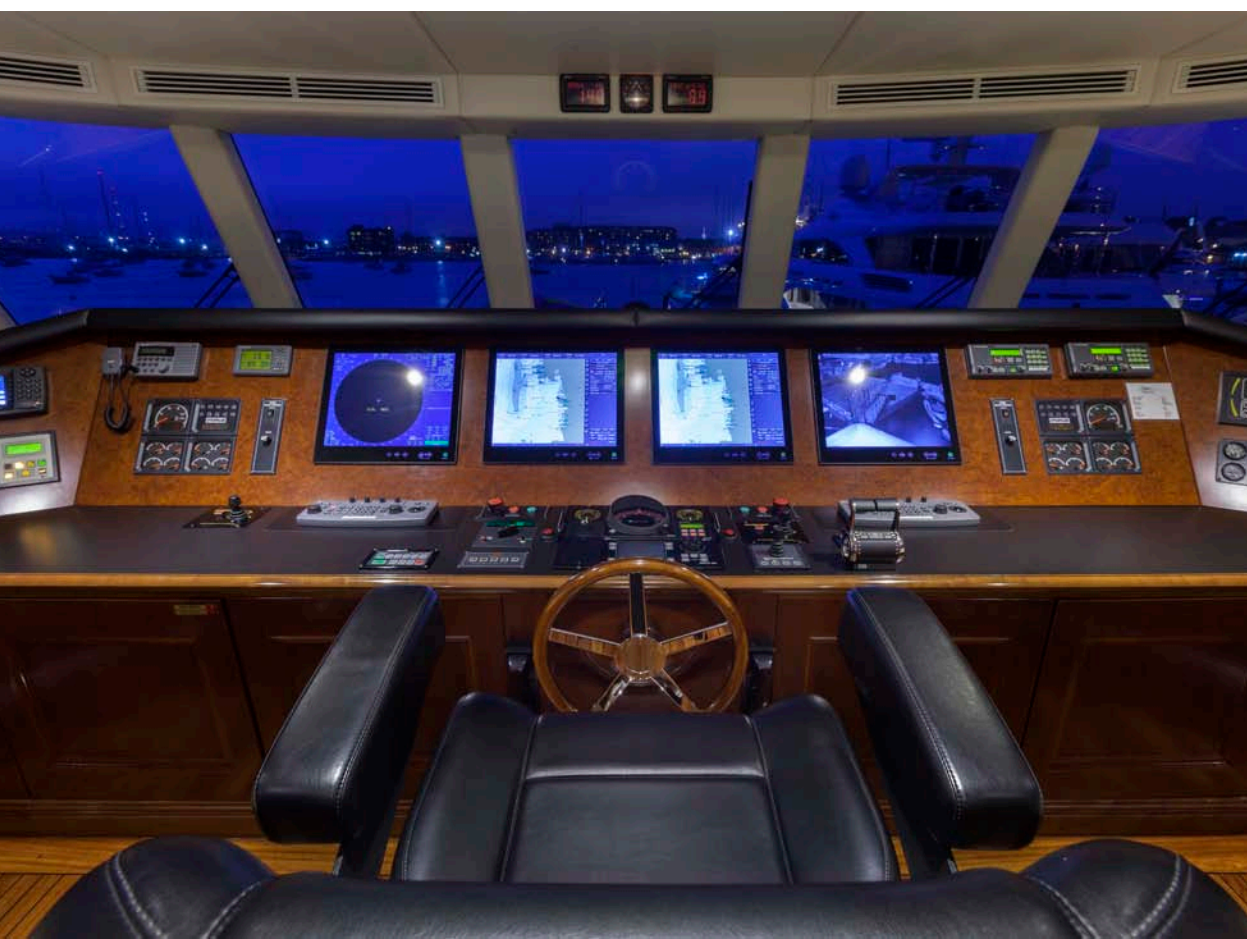

Enter the full-beam Master Suite through a set of double doors and find yourself in a private study with desk and loveseat. The centerline King bed faces forward with a sofa to starboard and a vanity to port. Forward of the bedroom is the full-width bathroom which includes marble tile and countertops, his and hers sinks, dual water closets, separate shower stall, and Jacuzzi tub.



MASTER BATHROOM











KING SUITE



KING SUITE BATHROOM



QUEEN SUITE

Below are the four remaining guest suites. The mirror-image VIP staterooms are each furnished with King beds and marble-tiled bathrooms with Jacuzzi tubs and double sinks. Forward and to port is a Queen stateroom while starboard sits the Dual-Twin stateroom. These suites include ensuite bathrooms, both with shower stalls, single sinks and ample storage.

KING SUITE



TWIN SUITE







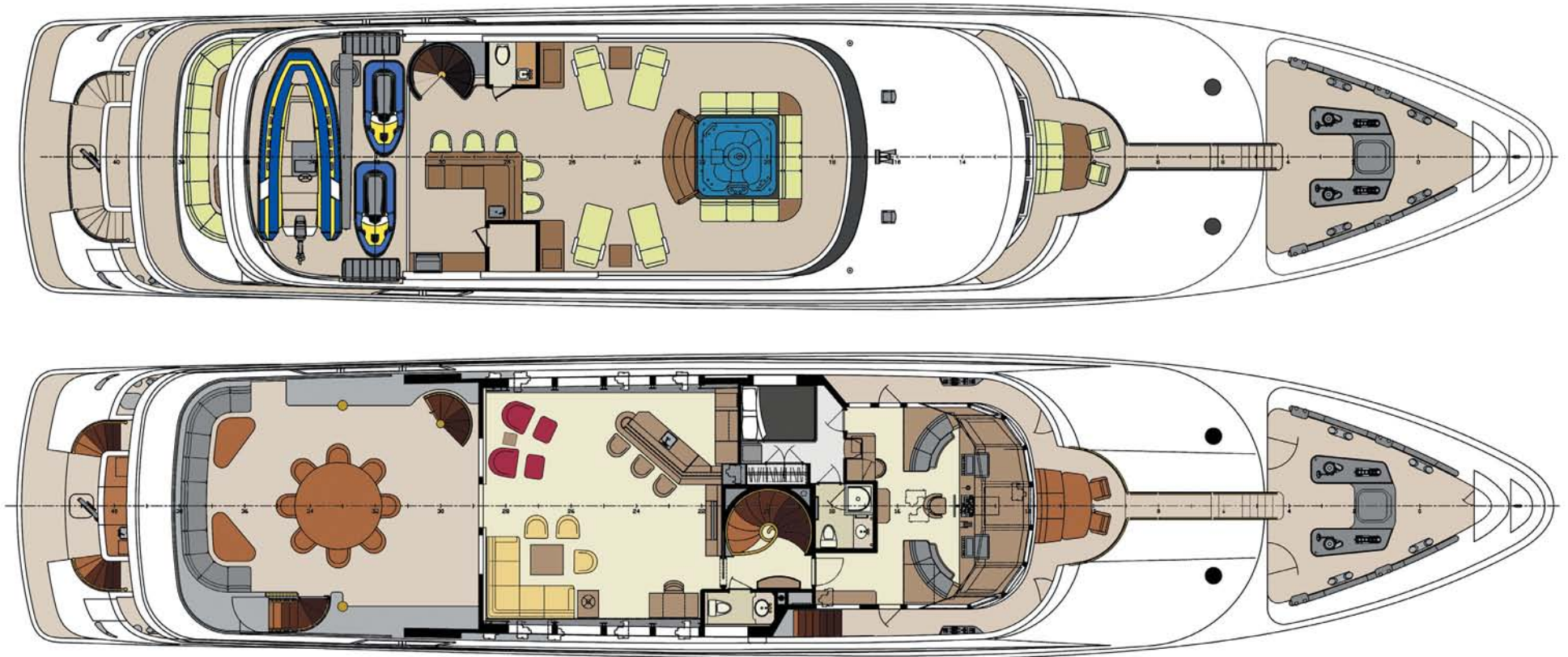

SPECIFICATIONS

10 guests in 5 staterooms

Builder: Trinity

Year/Refit: 2004/2014

Length: 142' (43m)

Beam: 28' (8.53m)

Draft: 7'2" (2.18m)

Hull: Aluminum

Engines: 2 x Caterpillar 3512B

Speed: Cruise 12.5 knots / Max 19 knots

Consumption: 80 US gallons (303 litres) per hour at 12.5 knots

ACCOMMODATION

Main Deck: Full beam Master Stateroom with King bed & seating area

Lower Deck: 2 King Staterooms with Jacuzzi tubs, 1 Queen & 1 Twin

ENTERTAINMENT

Satellite Television, plasma screens throughout

LCD screens on Sun Deck and Bridge Deck Aft

Surround sound in Main Salon & Skylounge

Kaleidescape entertainment system operated by iPads throughout

iPod/MP3 auxiliary connections in all Staterooms

Pramberger baby grand piano in Main Salon



TENDERS & TOYS

33' Intrepid towed Tender with 2 x 350hp Yamaha Outboards

18' Nautica with Yamaha 115 hp 4-stroke

2 x Yamaha FX 3-person Waverunners

2 x 2 person Kayaks, Snorkel Gear (adults and children), 2 x 10'2" Paddle Boards, Water Skis (adults and children), Wakeboards & Kneeboards, towable toys, 22' Trampoline, Banana, Rave, Fishing Gear & BBQ Beach Gear

SCUBA Gear for Rendezvous diving ONLY

AMENITIES

Jacuzzi & Bar on Sundeck with chaise lounge chairs

Adjustable Sun Awnings

Yoga & Fitness Equipment & 2 x Treadmills

Aft Deck is fully air-conditioned

WiFi, SatFax, Printer & Scanner

TURN THE KEY TO A YACHTING HOLIDAY ADVENTURE ABOARD CHEVY TOY

