

# ANNE VIKING

C H A R T E R   Y A C H T







ANNE VIKING

MASTER STATEROOM









## KEY FEATURES

- › Cruising in narrow waters and can take you close to waterfalls, cliffs, old fishing villages and historic sites. A ride on the world's steepest railway and glacier exploring are some of the activities offered onboard
- › The Captain can organize kayaking, sea rafting, horse-and- buggy rides and a tour of a Norwegian fish farm.
- › Guests can go fishing with experienced fishermen on fjords and rivers
- › Local captain and crew – remains the same every season.

ANNE VIKING



# AMENITIES

- Vast and spacious sundeck
- Well maintained year on year - great interior space
- Highly trained chef on board



ANNE VIKING

# TENDERS & WATER TOYS

- Avon 400DL (jet-rib)
- Waterskis
- Donut
- Fishing equipment:
  - fishing rods
  - fishing lines
  - fishing reels



# SPECIFICATIONS

Accommodates	8 Guests in 4 Staterooms
Arrangements	1 Pullman, 1 King, 1 Queen, 4 Single
Length	84'5" (25.72m)
Beam	20' (6.10m)
Draft	5'7" (1.70m)
Year / Refit	2004
Builder	Princess
Engines	Twin MTU 16V 2000hp
Cruising Speed	20 knots
Max Speed	34 knots
Fuel Consumption	400 l/hr @ 20 knots
Range	400 nm @ 20 knots
GRT	90

ANNE VIKING



GENERAL ARRANGEMENT

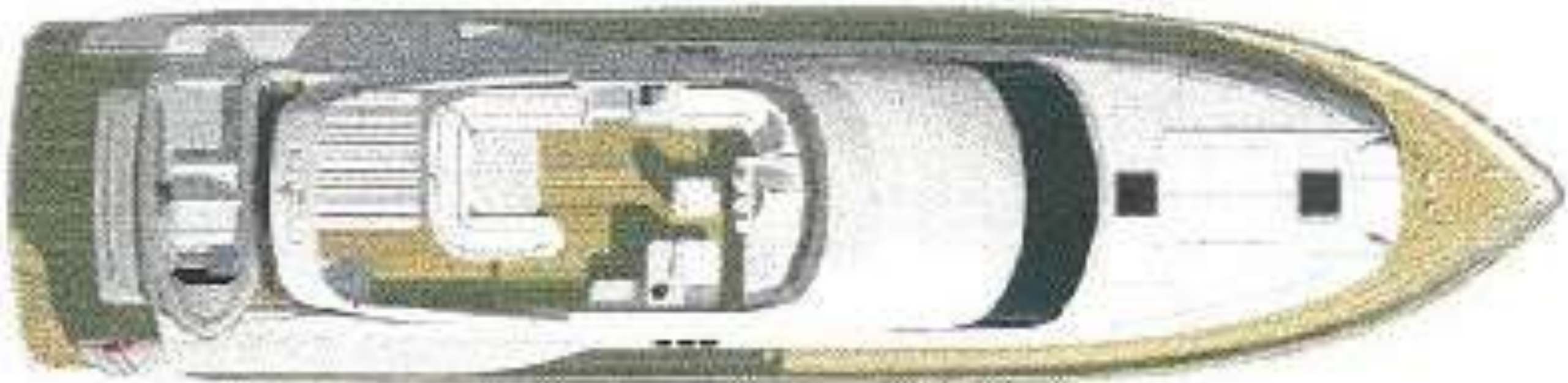

Alternative Cabin Configuration

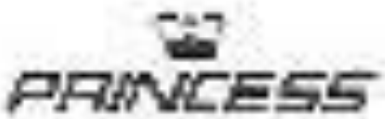
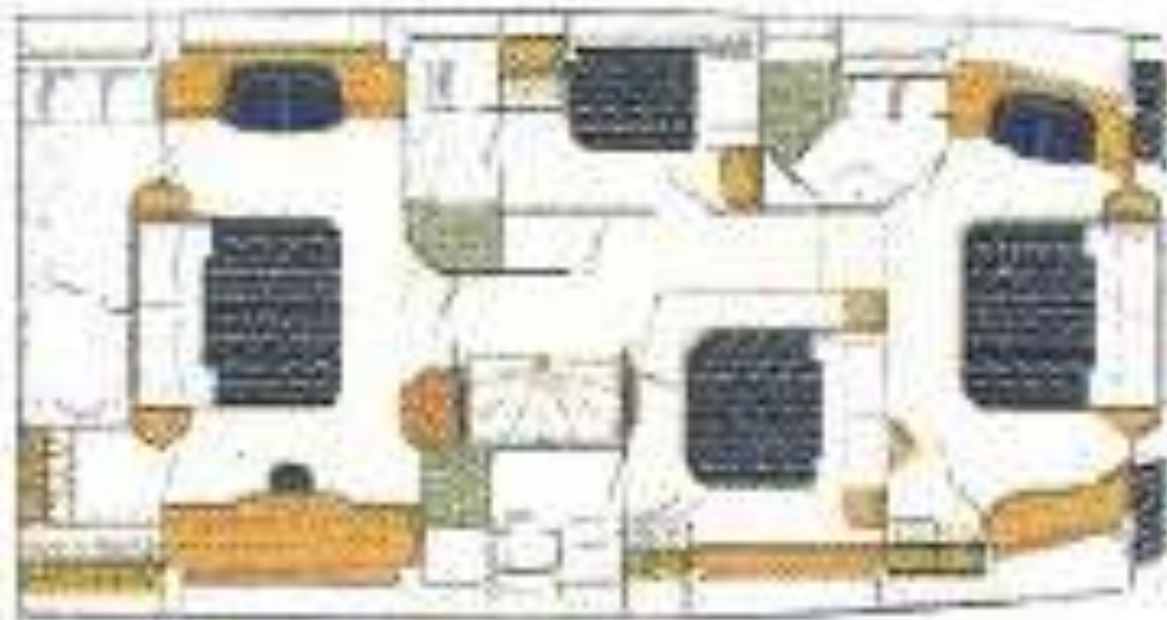

ANNE VIKING

C O N T A C T   Y O U R   C H A R T E R   B R O K E R