

AGRAM

C H A R T E R Y A C H T











AGRAM



MASTER CABIN











AGRAM



TWIN CABIN (CONVERTED)





TENDERS & WATER TOYS

- Jet Tender Cirus 6.50m (260 BHP),
- Jet Ski Yamaha SVHO 260 BHP,
- Jet Ski Yamaha FX SHO 160 BHP,
- Sea Doo RS3 Underwater Scooter
- Stand UP Paddle board ,
- Wake board, Kayak.
- Doughnut, Banana,
- Snorkelling equipment,
- Dive gear (RDV diving ONLY).



KEY FEATURES

- Stylish and modern interior
- Upper Salon can be converted as an extra guest cabin
- Accommodates 12 Guests in 6 elegant Cabins
- Very spacious flybridge
- Supersize jacuzzi on flybridge
- Ample space for sunbathing
- A wide selection of water toys
- Experienced and long term crew

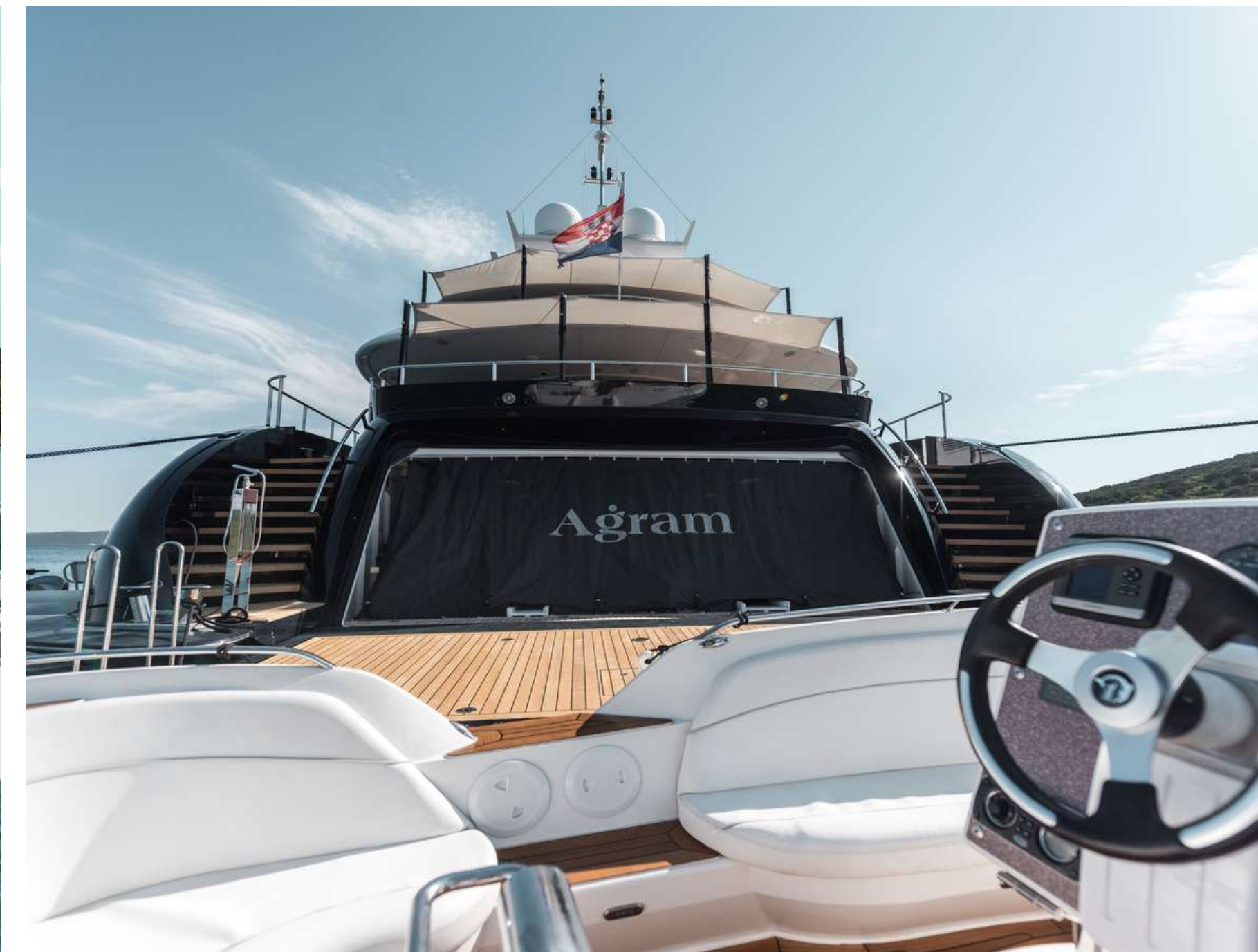

SPECIFICATIONS

Accommodates	12 Guests in 6 Staterooms
Arrangements	1 King, 3 Queen, 2 Convertible, 1 Pullman
Length	144'11" (44.17m)
Beam	29'6" (9.00m)
Draft	8'2" (2.50m)
Year / Refit	2008 / 2016
Builder	HEESEN
Interior Designer	Omega Architects & Heesen
Engines	2 x MTU / 3,699 hp each
Cruising Speed	14 knots
Max Speed	24 knots
Fuel Consumption	850 l/hr @ 14 knots
Range	3200 nm @ 12 knots
GRT	458

A G R A M



GENERAL ARRANGEMENT

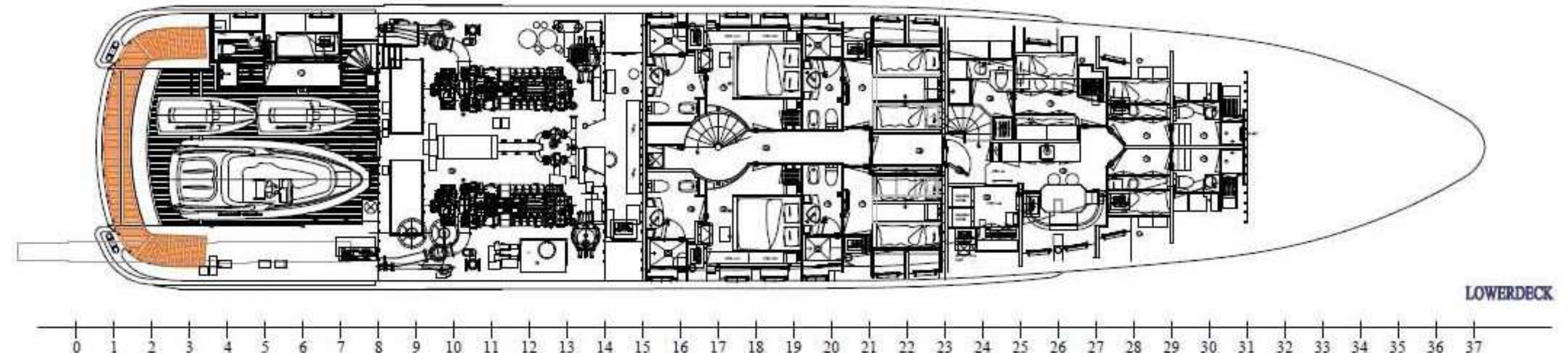
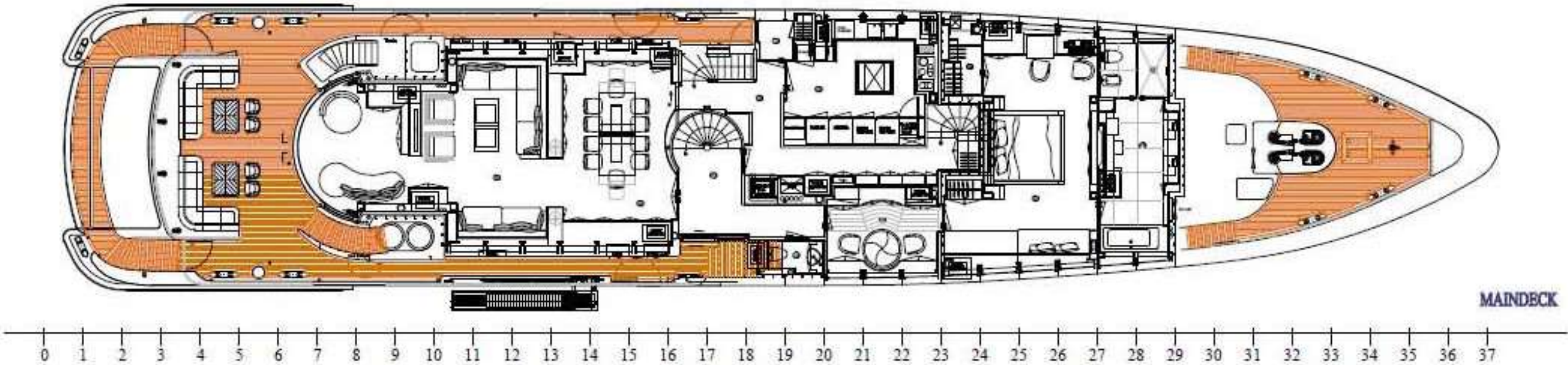
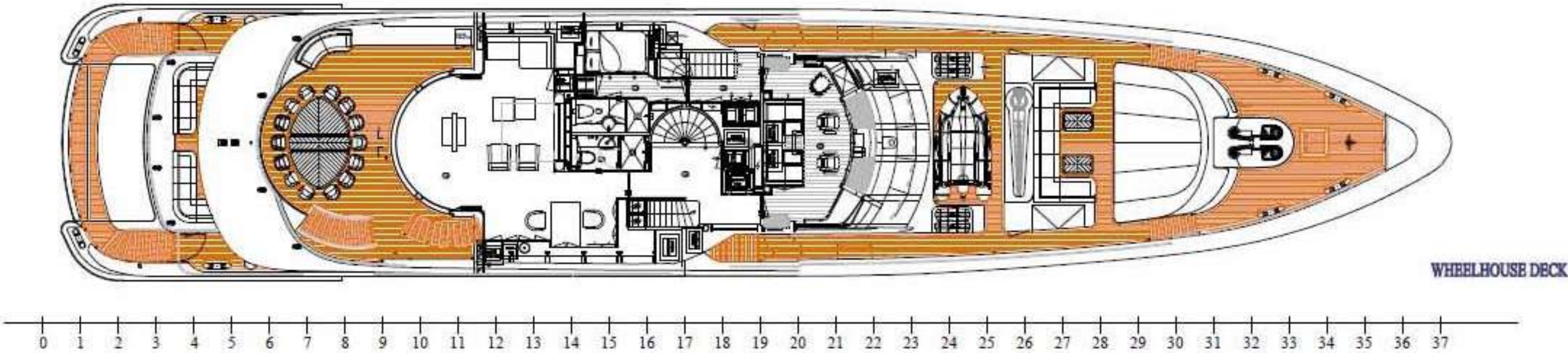
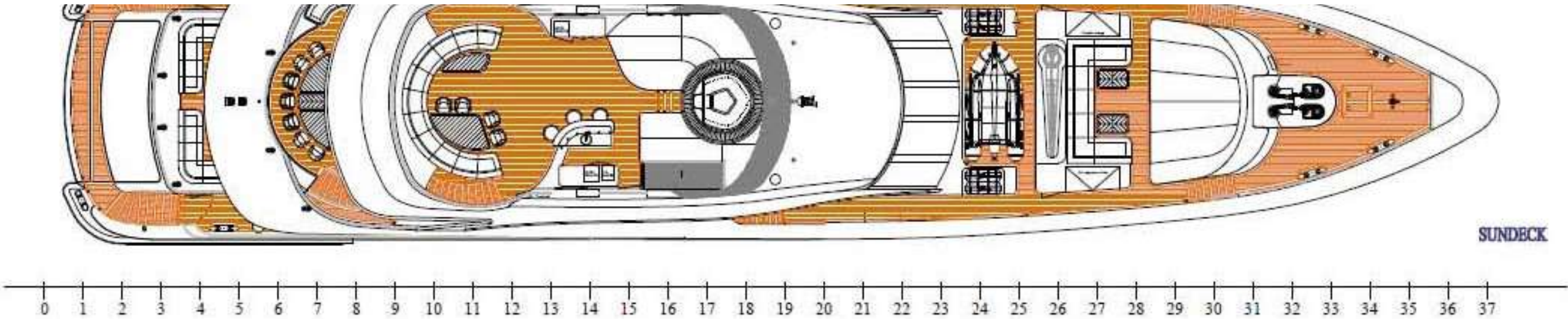

AGRAM

C O N T A C T Y O U R C H A R T E R B R O K E R