

FOR CHARTER

# BEATRIX





BUILDER	CANTIERI DI TERMOLI
BUILT	2015
BEAM	9.50M / 31' 2"
STATEROOMS	6
GUESTS	12
CREW	12
SPEED	12 KNOTS / 14 MAX
CRUISING AREA SUMMER	WEST MEDITERRANEAN
CRUISING AREA WINTER	PLEASE ENQUIRE
WEEKLY RATE HIGH	€ 230,000
WEEKLY RATE LOW	€ 210,000

EXPERT'S VIEW

*"Accommodating 12 guests in four elegant doubles and two twins, including a full beam Owner's suite and a VIP on the upper deck, Beatrix's original layout features a separate formal dining area on the main deck and a wellness area on the sundeck including a gym room, a large hammam and a deck Jacuzzi.  
The woodwork and the combination of soft colours further enhances the natural flow of light through the large windows".*

Yachts offered are subject to availability. The particulars are believed to be correct but are not guaranteed and may not be used for contractual purposes. Specification provided for information only.



































































































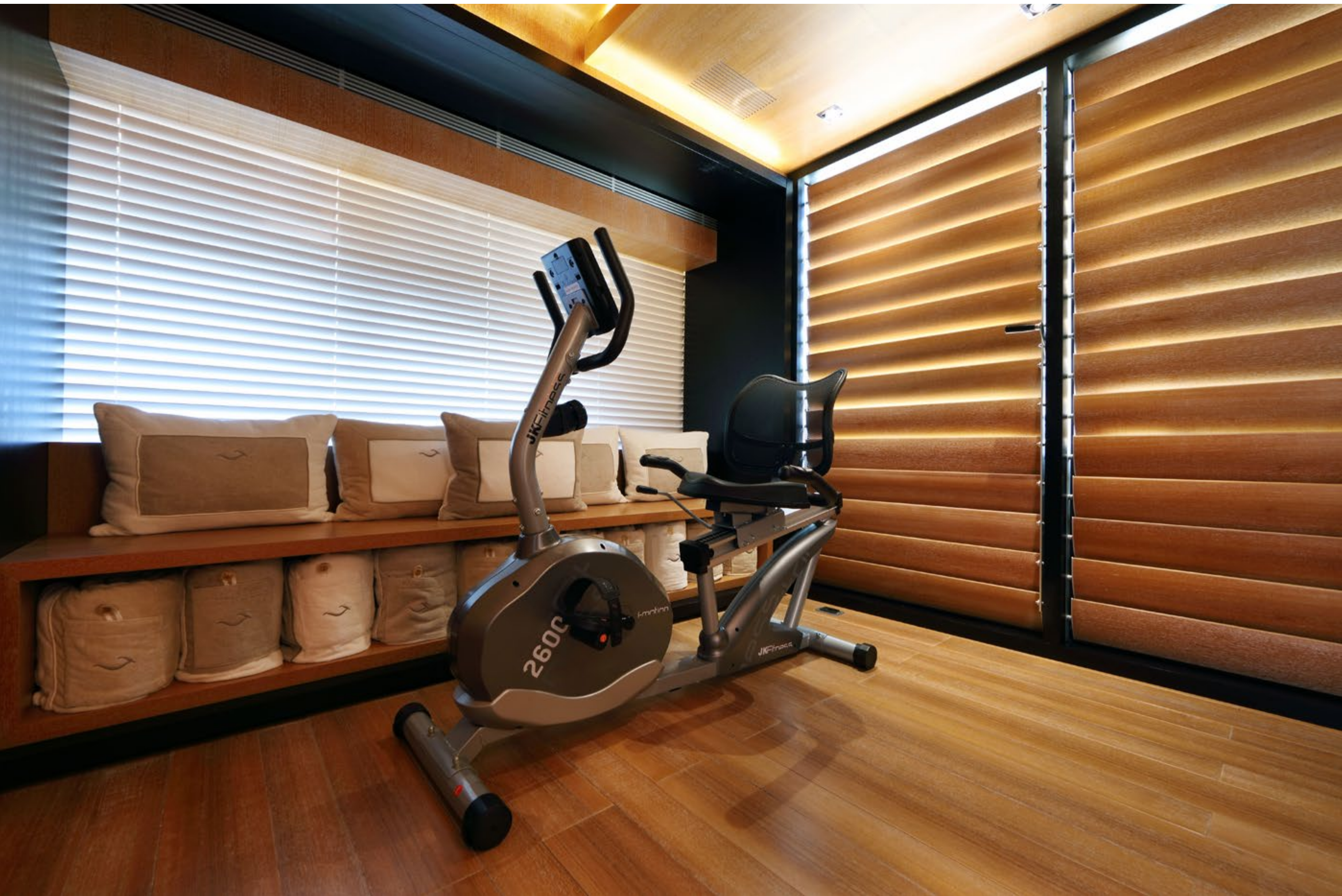















### TENDERS & TOYS

1 X 6.2M CASTOLDI JET TENDER (12 PAX)

1 X 4.5M RESCUE TENDER

SEA DOO ( JET-SKI ) GTI - 100 KW

SEA DOO ( JET-SKI ) GTX - 180 KW

2 X KAYAK

2 X SEA BOB

SWIMMING FLOATING PLATFORM

SPINERA

WING JP2

WAKEBOARD

WATERSKI

SUBLU

2 X PADDLE BOARDS

SNORKELING EQUIPMENT

FISHING EQUIPMENT

Yachts offered are subject to availability. The particulars are believed to be correct but are not guaranteed and may not be used for contractual purposes. Specification provided for information only.



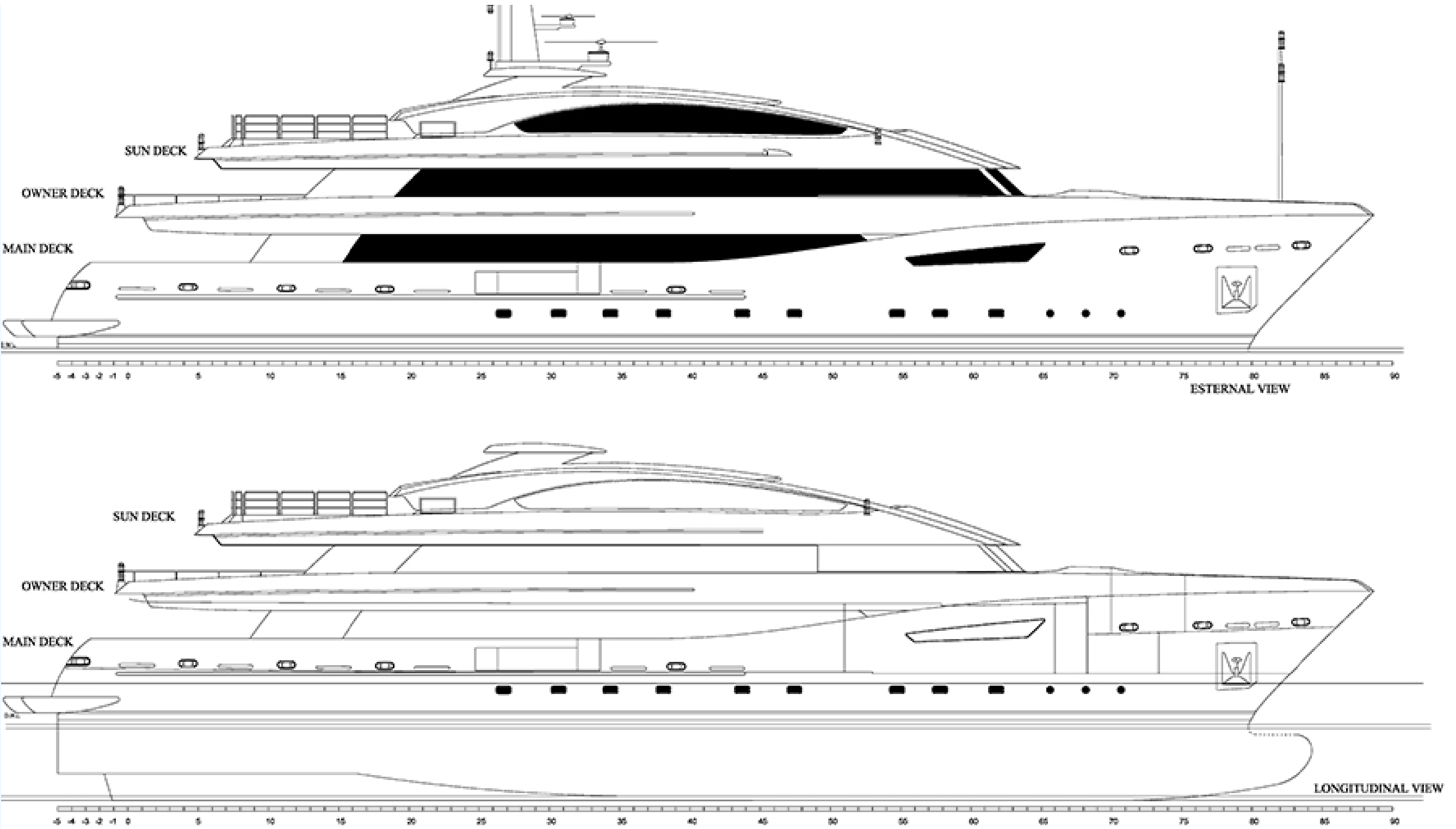

Yachts offered are subject to availability. The particulars are believed to be correct but are not guaranteed and may not be used for contractual purposes. Specification provided for information only.



## YACHT FOR CHARTER | BEATRIX | 50M / 164'01" | GENERAL ARRANGEMENT

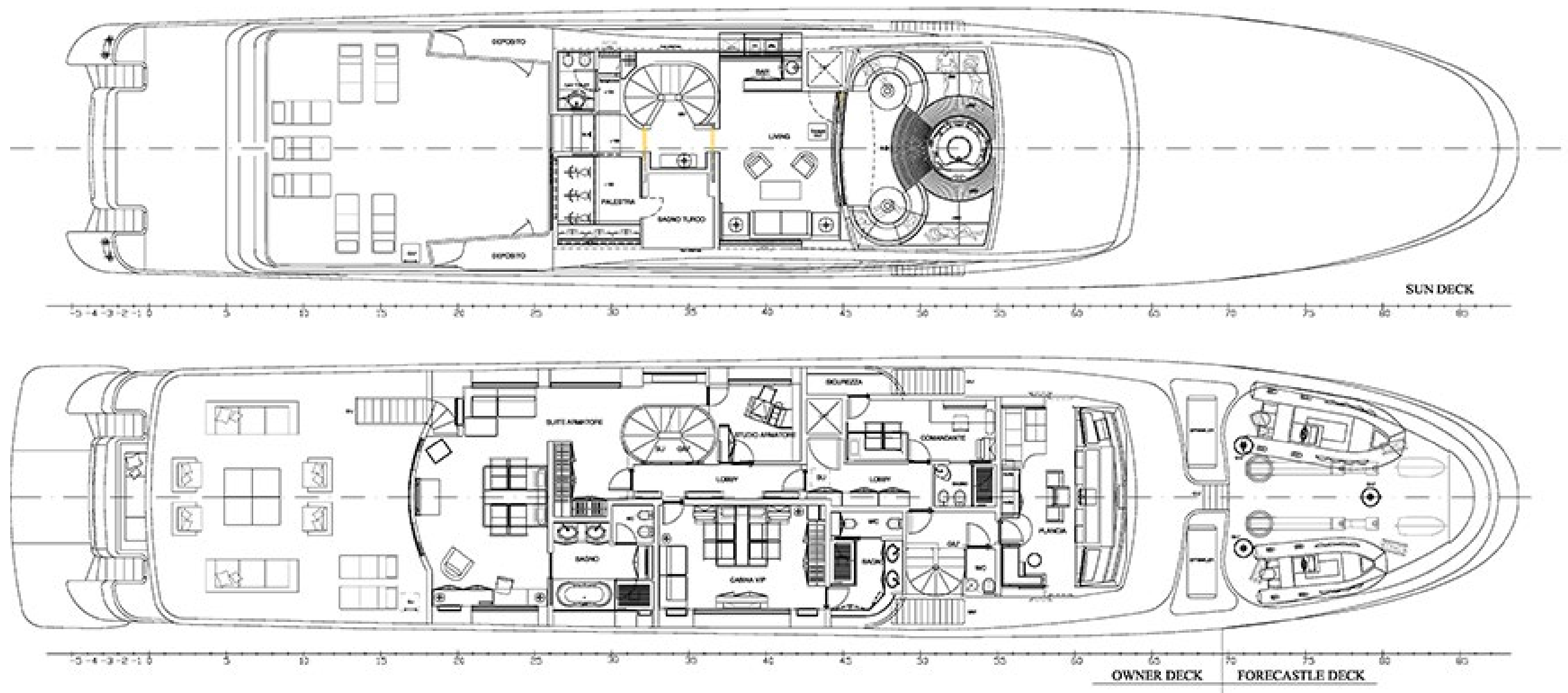

Yachts offered are subject to availability. The particulars are believed to be correct but are not guaranteed and may not be used for contractual purposes. Specification provided for information only.



